

certified mail – return receipt requested

December 21, 2010



Southern Trinity Groundwater Conservation District  
P.O. Box 2205  
Waco, Texas 76703

Re: City of Bellmead  
McLennan County, Texas  
Water Conservation Plan

Gentlemen:

Please find enclosed the final Water Conservation Plan for the City of Bellmead.

Should you have any questions, please contact our office.

Yours very truly,

TABOR & ASSOCIATES, INC.

  
Johnny M. Tabor, P.E.  
President

# Water Conservation Plan

# *City of Bellmead*



Prepared by:

**TABOR & ASSOCIATES, INC.**  
CONSULTING ENGINEERS – Firm #F-3229  
1005 SOUTH 18TH STREET \*\* P.O. BOX 1788  
WACO, TEXAS 76703  
TELEPHONE: 254-756-2118

## Table of Contents

Section 1: Introduction

Section 2: Service Area Description

Section 3: Water System Description

Section 4: Wastewater System Description

Section 5: Water Utility Profile

Section 6: Water Conservation Opportunities and Goals

Section 7: The Plan

Section 8: Implementation, Audits and Tracking

Section 9: Regional Water Planning Provisions

Exhibit "A" – Water Utility Profile

Exhibit "B" – Rate Structure

Exhibit "C" – CCN Map

Exhibit "D" – Facilities Diagram

Exhibit "E" – City Ordinance

Exhibit "F" – Transmittal Confirmations

- a. Texas Water Development Board
- b. Brazos G Regional Planning
- c. Southern Trinity Groundwater Conservation District

Section 1: Introduction:

This Water Conservation Plan is presented by the City of Bellmead pursuant to the requirements of the Texas Water Development Board (TWDB) and the Texas Commission on Environmental Quality (TCEQ). This plan has been developed through consultations with City of Bellmead staff, the City's Consulting Engineer, Tabor & Associates Inc., and the Texas Water Development Board personnel utilizing guidance from the publications made available from the Texas Water Development Board. The plan will meet the requirements of 2007 House Bill 4 requiring water conservation plans for systems serving 3300 or more connections.

The Water Conservation Plan organizes the implementation of a group of procedures for reducing the consumption of water, reducing the loss or waste of water, improving or maintaining the efficiency in the use of water and increasing recycling/reuse of water. The procedures identified are based on best management practices measures to try to meet targets and goals identified in the plan.

This plan should not be confused with the Drought Contingency Plan (Emergency Demand Management) which is a combination of strategies for responding to temporary and potentially reoccurring water supply shortages and other water supply and distribution emergencies.



Section 2: Service Area Description:

The City of Bellmead is located in McLennan County east of the Brazos River and is bordered to the north by the City of Lacy-Lakeview and to the east, south and west by the City of Waco. Major highways through the City of Bellmead include Interstate Highway 35, U.S. Highway 84, U.S. Highway 77, U.S. Highway 81, State Highway 31, and State Highway 340 loop. The Union Pacific Railroad also passes through the City. City of Bellmead provides water and wastewater utilities within the corporate boundaries of the City and within its extraterritorial jurisdiction.

Section 3: Water System Description:

The City of Bellmead produces its water supply from four wells drilled into the Trinity Aquifer and also contracts with the City of Waco for a supplemental emergency supply and this contract expires in 2016. The City of Bellmead wells are each located at a water plant which includes chlorination facilities, cooling towers, ground storage tanks and booster pumps. Three of the four water plants also include elevated storage tanks which maintain the pressure sufficient to deliver water through the City's distribution system. Two new water plants are planned for completion in the next five years. The first will include a new well, new chlorination facilities, new cooling tower, new ground storage tank, new booster pumps, and new elevated storage tank. The second includes a new well, new chlorination facilities and new cooling tower and will pump additional supply water to an existing plant.

Section 4: Wastewater System Description:

The City of Bellmead receives wastewater from its customers into the City's collection system. The collection system transports the wastewater to interceptors and/or a lift station which pumps the wastewater to an interceptor. The City owns and operates seven lift stations. The interceptors deliver wastewater to a metering station owned by the Waco Metropolitan Area Regional Sewer System(WMARSS). WMARSS is a regional wastewater treatment provider for multiple entities in McLennan County and has received and treated City of Bellmead wastewater since the early 1970s. The City contracts with WMARSS to receive, meter, transport and treat all of the City's wastewater.

Section 5: Water Utility Profile:

As an interval part of the Water Conservation Plan, the Texas Water Development Board requires that the City of Bellmead utilities be evaluated by completion of a Water Conservation Utility Profile Document (WRD-264). This document is an evaluation of the City's water and wastewater system records and includes customer use characteristics to identify water conservation opportunities and potential water saving targets and goals. This document is attached as Exhibit "A".

Section 6: Water Conservation Opportunities and Goals:

Research and development of this plan has identified several areas of opportunity in which the City will pursue the maintenance and expansion of its water conservation efforts by adopting the following goals to achieve the targeted long-term reduction in water consumption:

- a. GOAL : Reduce Unaccounted Water Loss  
TARGET: less than 118 gallons per capita per day by 2015  
less than 113 gallons per capita per day by 2020
  
- b. GOAL : Water Conservation Education  
TARGET: 1 gallon per capita per day less use by 2015  
2 gallons per capita per day less use by 2020
  
- c. GOAL : Promote Low-Flow Fixture Retrofit  
TARGET: 0.5 gallon per capita per day less use by 2015  
1.5 gallons per capita per day less use by 2020
  
- d. GOAL : Reduction of Irrigation Usages  
TARGET: 1 gallon per capita per day less summer use by 2015  
2 gallons per capita per day less summer use by 2020

Section 7: The Plan:

The City currently employs numerous Water Conservation oriented programs and efforts. In consideration of conserving its water supply, the City has begun to expand its water conservation program to include more specific elements and to verify their effects.

a. Reduce Unaccounted Water Loss:

Unaccounted Water Loss is water that is supplied to the system that exits the system without being metered. Such uses include but are not limited to flushing the distribution mains, fire fighting, unmetered facilities, construction water, faulty metering and distribution pipe leaks. To reduce unaccounted water loss the City will promote and incorporate the following techniques:

1. Install meters at all water consumption facilities.
2. Use meters or accurate estimating techniques to account for water used for flushing mains, fire fighting and construction.
3. Test master meters annually.
4. Test or replace customer meters, based on meter life.
5. Promote use of smaller customer meters which more accurately meter low flows.

b. Provide and Promote Water Conservation

Education:

Substantial reduction in water consumption can be realized if the public is informed about water conservation practices. The City of Bellmead will continued to provide education to both staff and the public about how to save water in and around residences and businesses by expanding the use of the following techniques:

1. Provide water conservation literature and brochures to customers at public meetings locations.
2. New customer packets will include water conservation literature.
3. Water bills will include water conservation information.
4. Public lectures and presentations will be conducted and promoted by the City.
5. Special conservation communications will be presented in the spring of each year in news media articles, City message boards and websites to encourage summertime conservation.

- c. **Promote Low-flow Plumbing Fixture Retrofit:**  
Through the education and information program, plumbers and water consumers will be encouraged to retrofit old fixtures (such as plumbing fixtures, lawn watering equipment, and water using appliances) with water saving devices. The educational process will focus on the advantages of installing water conservation devices as well as the availability of these items.
- d. **Promote Reduction of Irrigation Usages:**  
The City will promote reduced irrigation landscaping through the education and information program. Information about plant species which require less water will be provided to existing customers and builders through this program to encourage reduced irrigation. Publishing the cost advantages of more water efficient lawns and landscaping will promote existing landscape retrofitting.
- e. **Study Water Conservation Rate Structure:**  
The City currently employs a rate structure which is not “promotional”(does not encourage excessive use) consisting of a monthly minimum charge, which includes 2000 gallons of water, plus an additional unit charge per thousand gallons for all water used in excess of 2000 gallons. A higher



additional unit charge per thousand gallons is applied to those customers outside city limits. The monthly base charge is the same for all customers. A copy of the rate structure is attached as Exhibit “B”.

A study will be conducted to evaluate the potential water conservation benefits when water conservation features are added to the rate structure

Examples of such features could include the following:

1. Monthly base charge based on meter size
2. Elimination of water included in base charge
3. Increasing the charge per thousand for the higher users
4. Seasonal rates based on the customers seasonal variation from summer to winter

Section 8: Implementation, Audits and Tracking:

The City Manager or his/her duly appointed representative will act as the manager of the Water Conservation Plan. The City Manager will be responsible for maintaining appropriate records for program verification and will supervise the execution and implementation of the elements contained herein.

The City of Bellmead is required under 31 PHC 363.71 to provide an annual report which describes the implementation, and quantitatively tracks the water conservation program relative to the targets and goals identified in the plan. This annual report is due prior to May 1st of each year and will be prepared under the supervision of the City Manager in accordance with the format published by the Texas Water Development Board.

In addition to the annual report and audit for Texas Water Development Board, the City will audit its water consumption monthly to identify separately the total diverted water compared to the total water sold, water used for flushing, firefighting, water leak losses and other contributors to the total diverted water. The monthly audit will be used to evaluate the City's progress in implementation of its Water Conservation Plan.

Section 9: Regional Water Planning Provisions:

The City of Bellmead is located within the Brazos G Water Planning Area and Southern Trinity Groundwater Conservation District. The City will deliver a copy of the approved Water Conservation Plan to each of these entities and thereafter communicate and coordinate its efforts for water conservation to promote the successful efforts of each.

*Appendix “A”*  
*Water Utility*  
*Profile*

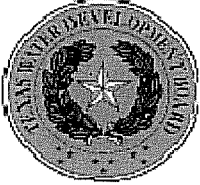

## TEXAS WATER DEVELOPMENT BOARD

### UTILITY PROFILE

The purpose of the Utility Profile is to assist with water conservation plan development and to ensure that important information and data be considered when preparing your water conservation plan and its target and goals. Please complete all questions as completely and objectively as possible. See *Water Conservation Plan Guidance Checklist* (WRD-022) for information on other water conservation provisions. You may contact the Municipal Water Conservation Unit of the TWDB at 512-936-2391 for assistance.

#### APPLICANT DATA

Name of Utility: City of Bellmead

Address & Zip: 3015 Bellmead Drive, Bellmead, Texas 76705

Telephone Number: 254-799-2436 Fax: 254-799-5969

Form Completed By: Johnny M. Tabor, P.E. Title: City Engineer

Signature: \_\_\_\_\_

Date: 4-1-10

**Name and Phone Number of Person/Department** responsible for implementing a water conservation program:

Name: Victor Pena, City Manager

Phone: 254-799-2436

#### UTILITY DATA

##### I. CUSTOMER DATA

##### A. Population and Service Area Data

1. Please attach a copy of your Certificate of Convenience and Necessity (CCN) from the TCEQ
2. Service area size (square miles): (See attached Exhibit "C")

3. Current population of service area: **9500**

4. Current population served by utility:

a: water **9500**

b: sewer **9055**

5. Population served by water utility for the previous five years:

Year	Population
2008	9500
2007	9622
2006	9605
2005	9727
2004	8371

6. Projected population for service area in the following decades:

Year	Population
2010	9572
2020	9932
2030	10292
2040	10652
2050	11012

7. List source(s)/method(s) for the calculation of current and projected population:  
Utility service and Census population used to project 10 year straight line growth

**B. Active Connections**

1. Current number of active connections by user type. If not a separate classification, check whether multi-family service is counted as Residential \_\_\_\_\_ or Commercial \_\_\_\_\_

<u>Treated Water Users</u>	<u>Metered</u>	<u>Non-metered</u>	<u>Total</u>
Residential-Single Family	<b><u>3126</u></b>		<b><u>3126</u></b>
Residential-Multi-Family	<b><u>36</u></b>		<b><u>36</u></b>
Commercial	<b><u>195</u></b>		<b><u>195</u></b>
Industrial			
Public			
Total	<b><u>3357</u></b>		<b><u>3357</u></b>

2. List the net number of new connections per year for most recent three years:

Year	2008	2007	2006
Residential-Single Family	<u>195</u>	<u>156</u>	<u>147</u>
Residential-Multi-Family	<u>10</u>	<u>14</u>	<u>15</u>
Commercial	<u>19</u>	<u>13</u>	<u>9</u>
Industrial			
Public			
Other			

C. High Volume Customers

List annual water use for the five highest volume retail and wholesale customers  
(Please indicate if treated or raw water delivery.)

	<u>Customer</u>	<u>Use (1,000 gal./yr)</u>	<u>Treated or Raw</u>
(1)	Delta Inn	5,072	Treated
(2)	Motel 6	2,095	Treated
(3)	Country Inn Suites	2,532	Treated
(4)	Walmart	2,034	Treated
(5)	Bordeaux Apts	10,039	Treated
(6)	LaVega I.S.D.	4,700	Treated

**II. WATER USE DATA FOR SERVICE AREA**

**A. Water Accounting Data**

1. Amount of water pumped use for previous five years (in 1,000 gal.):  
 Please indicate: Diverted Water:  (pumped at wells)  
 Treated Water:

Year	2008	2007	2006	2005	2004
January	35,280	31,563	34,810	31,855	27,995
February	36,077	29,633	30,244	28,867	27,626
March	39,191	31,946	33,978	32,684	31,032
April	40,034	30,865	35,993	29,235	33,798
May	36,493	32,966	36,879	29,533	37,277
June	43,309	34,316	44,348	39,453	40,380
July	51,592	35,137	47,632	48,075	39,496
August	42,249	41,351	52,884	44,704	39,994
September	39,278	39,615	42,424	45,852	29,758
October	38,808	39,223	39,267	42,739	30,314
November	35,713	34,571	33,898	36,653	28,790
December	35,445	34,536	32,757	35,634	31,657
<b>Total</b>	<b>473,469</b>	<b>415,722</b>	<b>465,114</b>	<b>445,284</b>	<b>398,117</b>

Please indicate how the above figures were determined (e.g. from a master meter located at the point of a diversion from a stream or located at a point where raw water enters the treatment plant, or from water sales).

**Master Meter located at each point.**

2. Amount of water (1,000 gallons) delivered (sold) as recorded by the following account types (See #1, Appendix A) for the past five years.

Year	Residential (SF)	Residential (MF)	Commercial	Total Sold
<b>2008</b>	199,660	23,437	110,987	334,084
<b>2007</b>	195,607	23,313	101,647	320,567
<b>2006</b>	213,743	29,415	132,765	375,923
<b>2005</b>	228,200	17,382	105,442	351,024
<b>2004</b>	342,380	27,470	28,266	398,116



3. List previous five years records for water loss (See #2, Appendix A)

Year	Amount (gal.)	% Loss
2008	139,385,000	42%
2007	95,155,000	30%
2006	89,191,000	24%
2005	94,260,000	27%
2004	1,000	0%

4. List previous five years records for annual peak-to-average daily use ratio (See #3, Appendix A)

Year	Average MGD	Peak Day MGD	Ratio
2008	1.297	1.664	1.283
2007	1.139	1.334	1.171
2006	1.274	1.706	1.339
2005	1.220	1.551	1.271
2004	1.091	1.251	1.147

5. Total per capita water use for previous five years (See #4, Appendix A):

Year	Population	Total Diverted (or Treated Less Wholesale Sales) (1000 gal)	Per Capita (gpcd)
2008	9500	473469	137
2007	9622	415722	118
2006	9605	465114	133
2005	9727	445284	125
2004	8371	398117	130
AVERAGE			<b>129</b>

6. Seasonal water use for the previous five years (in gallons per person per day) (See #5, Appendix A):

Year	Population	Base Daily Per Capita Use	Summer Daily Per Capita Use
2008	9500	125	160
2007	9622	111	128
2006	9605	113	168
2005	9727	110	151
2004	8371	116	159

**B. Projected Water Demands**

Project water supply requirements for at least the next ten years using population trends, historical water use, and economic growth, etc. Indicate sources of data and how projected water demands were determined.

Attach additional sheets if necessary.

YEAR	2020	2030	2040	2050
Projected Yearly Use (million gallons)	495	513	531	549

### III WATER SUPPLY SYSTEM

#### A. Water Supply Sources

List all current water supply sources

	<u>Source</u>	<u>Amount Available</u>
Surface Water:	N/A	MGD
Groundwater:	4 Wells @ 550 GPM each	3.17 MGD
Contracts:	City of Waco	MGD
Other:		MGD

#### B. Treatment and Distribution System

1. Design daily capacity of system: 6000 meters
2. Storage Capacity: Elevated 600,000 gal. Ground 3,500,000 gal.
3. If surface water, do you recycle filter backwash to the head of the plant?  
Yes  
No N/A  
If yes, approximately MGD
4. Please describe the water system. Include the number of treatment plants, wells, and storage tanks. If possible, include a sketch of the system layout.  
**See Exhibit "D" - Facilities Diagram**

#### IV. WASTEWATER UTILITY SYSTEM

##### A. Wastewater System Data

1. Design capacity of wastewater treatment plant(s):
2. Is treated effluent used for irrigation on-site, off-site, plant washdown, or chlorination/dechlorination?  
If yes, approximately gallons per mont. Could this be substituted for potable water now being used in these areas?
3. Briefly describe the wastewater system(s) of the area serviced by the water utility. Describe how treated wastewater is disposed of. Where applicable, identify treatment plant(s) with the TCEQ name and number, the operator, owner, and if, wastewater is discharged, the receiving stream. Please provide a sketch or map which locates the plant(s) and discharge points or disposal sites.

##### B. Wastewater Data for Service Area

1. Percent of water service area served by wastewater system:
2. Monthly volume treated for previous three years (in 1000 gallons):

<u>Year</u>	<u>2008</u>		<u>2007</u>		<u>2006</u>	
January	34.80	mgd	33.28	mgd	31.59	mgd
February	33.59	mgd	25.95	mgd	30.96	mgd
March	44.15	mgd	59.61	mgd	44.20	mgd
April	42.10	mgd	35.68	mgd	34.04	mgd
May	34.15	mgd	65.08	mgd	35.86	mgd
June	32.48	mgd	43.47	mgd	37.64	mgd
July	35.30	mgd	51.25	mgd	31.70	mgd
August	37.05	mgd	37.61	mgd	25.98	mgd
September	34.84	mgd	35.28	mgd	29.03	mgd
October	38.21	mgd	35.71	mgd	31.73	mgd
November	35.55	mgd	34.28	mgd	29.60	mgd
December	28.00	mgd	35.46	mgd	26.95	mgd
<b>Total</b>	<b>2438.22</b>	<b>mgd</b>	<b>2499.66</b>	<b>mgd</b>	<b>2395.28</b>	<b>mgd</b>

## Appendix A

### Definitions of Utility Profile Terms

1. **Residential** sales should include water sold to residential (Single and Multi-Family) class customers only.  
**Industrial** sales should include water sold to manufacturing and other heavy industry.  
**Commercial** sales should include water sold to all retail businesses, offices, hospitals, etc  
**Wholesale** sales should include water sold to another utility for a resale to the public for human consumption.
2. **Water Loss** is the difference between water a utility purchases or produces and the amount of water that it can account for in sales and other known uses for a given period. Water loss can result from:
  1. inaccurate or incomplete record keeping;
  2. meter error;
  3. unmetered uses such as firefighting, line flushing, and water for public buildings and water treatment plants;
  4. leaks; and
  5. water theft and unauthorized use.
3. The **peak-day to average-day ratio** is calculated by dividing the maximum daily pumpage (in million gallons per day) by the average daily pumpage. Average daily pumpage is the total pumpage for the year (as reported in Section IIA1, p. 4) divided by 365 and expressed in million gallons per day.
4. **Total use in gallons per capita per day** is defined as total average daily amount of water diverted or pumped for treatment for potable use by a public water supply system. The calculation is made by dividing the water diverted or pumped for treatment for potable use by population served. Indirect reuse volumes shall be credited against total diversion volumes for the purpose of calculation gallons per capita per day for targets and goals developed for the water conservation plan. Total water use is calculated by subtracting the wholesale sales from the total water diverted or treated (as reported in Section IIA1).
5. **Seasonal water use** is the difference between base (winter) daily per capita use and summer daily per capita use. To calculate the **base daily per capita use**, average the monthly diversions for December, January, and February, and divide this average by 30. Then divide this figure by the population. To calculate the **summer daily per capita use**, use the months of June, July, and August.

***Exhibit “B”***  
***Rate***  
***Structure***

**CITY OF BELLMEAD**

***Rate Structure***

**Water Rates:**

**\$17.00 for first 2,000 gallons**  
**\$3.50 per each additional 1,000 gallons metered**  
**\$5.20 for each additional 1,000 gallons outside City Limits**

**Late Fees:**

**\$20.00 if paid before 5:00 p.m. on day of turn off**  
**\$40.00 if paid after 5:00 p.m. in Police Department**  
**\$25.00 for returned items**

**Sewer Rates:**

**Residential: \$9.50 per first 1,000 gallons**  
**\$1.40 per each additional 1,000 gallons**  
**metered to maximum of \$21.00**

**Commercial: \$9.50 per first 1,000 gallons**  
**\$1.40 per each additional 1,000 gallons**  
**metered. No maximum**

**Taps:**

<b>3/4" Water</b>	<b>\$750.00</b>	<b>1 inch</b>	<b>Cost plus 15%</b>
<b>1-1/2" Water and above will be at cost</b>			
<b>4" Sewer</b>	<b>\$700.00</b>	<b>6 inch</b>	<b>Cost plus 15%</b>

*Exhibit “C”*  
*CCN Map*

***Exhibit “D”***  
***Facilities***  
***Diagram***



***Exhibit “E”***  
***City Ordinance***

ORDINANCE NO. 2010-009

AN ORDINANCE OF THE CITY OF BELLMEAD, TEXAS,  
ADOPTING A WATER CONSERVATION PLAN; PROVIDING FOR  
THE REPEAL OF ALL ORDINANCES IN CONFLICT; AND  
PROVIDING FOR AN EFFECTIVE DATE.

WHEREAS, it is necessary that a Water Conservation Plan be adopted by the City of Bellmead; and

WHEREAS, such a program has been formally submitted to the Texas Water Development Board for approval; and

WHEREAS, The City Council of the City of Bellmead believes that it is in the best interest of the City of Bellmead to adopt such program.

NOW, THEREFORE BE IT ORDAINED BY THE CITY COUNCIL OF THE CITY OF BELLMEAD, TEXAS,

Section 1: That the City of Bellmead Water Conservation Plan attached hereto as Exhibit "A" and made part hereof for all purposes be, and the same is hereby, adopted as the official policy of the City.

Section 2: That all ordinances of the City in conflict with the provisions of this ordinance be, and the same are hereby, repealed and all other ordinances of the City not in conflict with the provisions of this ordinance shall remain in full force and effect.

Section 3: Should any paragraph, sentence, subdivision, clause, phrase, or section of this ordinance be adjudged or held to be unconstitutional, illegal, or invalid, the same shall not affect the validity of this ordinance as a whole or any part or provision thereof, other than the part so declared to be invalid, illegal, or unconstitutional.

Section 4: This ordinance shall take effect immediately from and after its passage and the publication of the caption as the law in such cases provide.

***PASSED AND APPROVED*** by the City Council of the City of Bellmead, Texas on first reading on the 12<sup>th</sup> day of October, 2010.

***PASSED AND APPROVED*** by the City Council of the City of Bellmead, Texas on second reading on the 9<sup>th</sup> day of November, 2010.

**PASSED AND APPROVED** by the City Council of the City of Bellmead, Texas  
on third reading on the 14<sup>th</sup> day of December, 2010.

  
\_\_\_\_\_  
Mayor, City of Bellmead, Texas

ATTEST:

  
\_\_\_\_\_  
City Secretary, City of Bellmead, Texas

# *Exhibit “F”*

## *Transmittal*

### *Confirmations*

- 1. Texas Water Development Board*
- 2. Brazos G Regional Planning*
- 3. Southern Trinity Groundwater  
Conservation District*

via FedEx

December 21, 2010



Mr. Ethan Ham  
Water Conservation Division  
Texas Water Development Board  
1700 N. Congress Avenue  
Austin, Texas 78701

Re: City of Bellmead  
McLennan County, Texas  
Water Conservation Plan

Dear Mr. Ham:

Please find enclosed the final Water Conservation Plan for the City of Bellmead.

Should you have any questions, please contact our office.

Yours very truly,

TABOR & ASSOCIATES, INC.

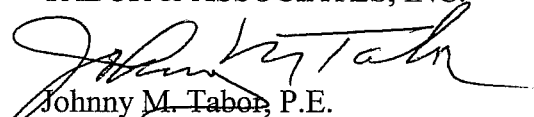
  
Johnny M. Tabor, P.E.  
President

certified mail – return receipt requested

December 21, 2010



Southern Trinity Groundwater Conservation District  
P.O. Box 2205  
Waco, Texas 76703

Re: City of Bellmead  
McLennan County, Texas  
Water Conservation Plan

Gentlemen:

Please find enclosed the final Water Conservation Plan for the City of Bellmead.

Should you have any questions, please contact our office.

Yours very truly,

TABOR & ASSOCIATES, INC.

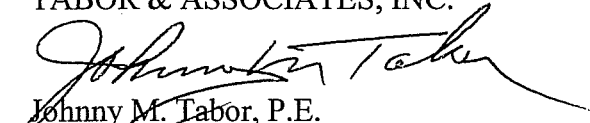
  
Johnny M. Tabor, P.E.  
President

certified mail – return receipt requested

December 21, 2010



Brazos G Water Planning Group  
Brazos River Authority  
P.O. Box 7555  
Waco, Texas 76714

Re: City of Bellmead  
McLennan County, Texas  
Water Conservation Plan

Gentlemen:

Please find enclosed the final Water Conservation Plan for the City of Bellmead.

Should you have any questions, please contact our office.

Yours very truly,

TABOR & ASSOCIATES, INC.

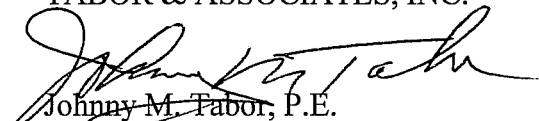
  
Johnny M. Tabor, P.E.  
President



SOUTHERN TRINITY GROUNDWATER CONSERVATION DISTRICT  
COUNTY OF MCLENNAN, STATE OF TEXAS

**HISTORIC USE PRODUCTION PERMIT**

**THIS CERTIFIES THAT:**

City of Bellmead  
3015 Bellmead Dr.  
Bellmead, Texas 76705  
Phone: 254-799-2436

(the "Permittee"), has applied for an Historic Use Production Permit to withdraw and place to beneficial use groundwater from within the District, and that the Board of Directors of the Southern Trinity Groundwater Conservation District ("District") has APPROVED the application as follows:

**1 Permit Category**

This permit is a **Historic Use Production Permit**.

**2 Permit Term**

The term of this permit is **perpetual**.

**3 Groundwater Source**

The source of groundwater is the **Trinity Aquifer**.

**4 Annual Groundwater Withdrawal Amounts**

Permittee may withdraw groundwater from the Trinity Aquifer for beneficial, nonwasteful use in a manner not to exceed the following volume: **1476.9910 Acre-Feet (481,279,000 Gallons) per calendar year**. This groundwater withdrawal amount has been calculated pursuant to Section 5.211 of the District's rules. It may be subject to proportional adjustment pursuant to Chapter 5, Subchapter B of the District's rules, as may be amended.

**5 Purpose of Use**

Permittee may use Trinity Aquifer groundwater only for **municipal purposes**.

**6 Well Name(s), Location(s), and Maximum Rate of Withdrawal**

Groundwater may only be withdrawn from the aquifer from a well(s) located at each of the location(s) and with a maximum rate of withdrawal(s) (flow rate) as follows:

<u>Name</u>	<u>Location (latitude/longitude)</u>	<u>Maximum Flow Rate</u>
Barlow # 2	N31D 35M 45S / W97D 05M 48S	400 gpm
Concord	N31D 36M 08S / W97D 05M 10S	700 gpm
Myers # 4	N31D 37M 8S / W97D 05M 32S	700 gpm



**SOUTHERN TRINITY GROUNDWATER CONSERVATION DISTRICT  
COUNTY OF MCLENNAN, STATE OF TEXAS**

Parrish # 1

N31D 35M 35S / W97D 06M 26S

600 gpm

**7 Measurement of Amount of Groundwater Withdrawn**

Permittee may only withdraw groundwater from a well that has an operating flow meter that meets the requirements of Chapter 8 of the District's rules.

**8 Place of Use**

Permittee may beneficially use Aquifer groundwater only within the Permittee's wholesale or retail water service area identified in the Certificate of Convenience and Necessity 10024, filed with the Texas Commission on Environmental Quality. Except as provided by 5.401(b) of the District's rules, as may be amended, if the place of use is not within the District's boundaries, Permittee must obtain a groundwater exportation permit from the District prior to the withdrawal of groundwater under the permit.

**9 Well Construction, Operation, Maintenance, Closure**

The well(s) identified in this permit shall be installed, equipped, operated, maintained, plugged, capped, or closed, as may be appropriate in accordance with the District's rules and all other applicable federal, state, and local laws, including by submitting a copy of a state plugging report to the District within 60 days after capping or plugging any well.

**10 Water Conservation**

Withdrawals of groundwater are required to be efficiently withdrawn and used in compliance with the District's rules and the District's water conservation plan, as may be amended, and Permittee's plan as approved by the District, as may be applicable.

**11 Conveyance to Place of Use**

Water authorized by this permit to be produced must be conveyed to the place of use in a manner to prevent evaporation, channel loss by percolation, or waste. Water conveyed greater than a distance of one-half mile from the wellhead where produced must be conveyed through a pipeline.

**12 Meters; Alternative Measuring Method**

Permittee shall install, operate and maintain the meter or alternative measuring method on the well(s) identified in this permit in compliance with the District's rules and the manufacturer's instructions.

**13 Reports**

Permittee shall timely file all applicable reports with the District on forms prescribed by the District as required by the District's rules, as may be amended, and other applicable law.

**SOUTHERN TRINITY GROUNDWATER CONSERVATION DISTRICT  
COUNTY OF MCLENNAN, STATE OF TEXAS**

**14 Fees**

Permittee shall timely pay and remain current on the payment of all applicable fees to the District.

**15 Interruption, Suspension, or Other Limitations Due to Drought**

Permittee shall reduce water supply and consumption during times of drought in accordance with the District's rules and the District's management plan and Permittee's plan approved by the District, as applicable.

**16 Groundwater Management Plan**

Permittee shall withdraw and use groundwater only in accordance with the District's approved groundwater management plan, as may be amended.

**17 Water Quality**

Permittee shall use diligence to protect the water quality of groundwater in the District and shall comply with the District's water quality rules and take no action that pollutes or contributes to the pollution of groundwater in the District.

**18 Transfers and Amendments**

Permittee may transfer or amend this permit only in compliance with the District's rules.

**19 Permit Review, Renewal or Extension Conditions**

Permittee is subject to any review, renewal or extension conditions stated in the permit or the District's rules.

**20 Change of Name, Address or Telephone Number**

Permittee shall provide written notice to the District of any change of ownership, name of Permittee or the authorized representative, well operator, mailing address or telephone number within 30 days of such change.

**21 Inspections by District**

Any authorized officer, employee, agent or representative of the District shall have the right at all reasonable times to enter upon lands upon which a well may be located within the boundaries of the District, including the well(s) identified in Paragraph 6 of this permit, for the purpose of inspecting or testing such wells, meters, pumps and the power units of a well or wells, collecting water samples, and making any other reasonable and necessary inspections and tests that may be required or necessary for the formulation or the enforcement of the permits, rules or orders of the District. Permittee has a duty to ensure that the well site is accessible to District representatives for inspection and to cooperate fully in any reasonable inspection of the well(s) and well site by District representatives.

**SOUTHERN TRINITY GROUNDWATER CONSERVATION DISTRICT  
COUNTY OF MCLENNAN, STATE OF TEXAS**

**22 Additional Conditions**

This permit is issued subject to the requirements of: (1) Chapter 8821, Texas Special District Local Laws Code; (2) Chapter 36, Texas Water Code, as may be amended; and (3) the District's Rules, as may be amended.

**23 Enforcement**

The District retains the right to take any and all enforcement actions within its legal authority to enforce compliance with the terms and conditions of this permit.

**24 Continuing Jurisdiction of District**

This permit is issued subject to the continuing jurisdiction of and supervision by the District, and may be amended from time to time consistent with applicable law, including if the District learns that any of the information set forth in this permit is incorrect on the date issued.

**25 Permit Recordation**

Within 30 days of the date of issuance of this approved permit from the District, Permittee shall record this permit with the County Clerk of every county in which the well(s) or place of use are located and provide a copy of the recorded permit to the District.

**26 References to Law**

Any reference in this permit to a statute, rule, or other law of any kind, that exists on the date of issuance of the permit includes all subsequent amendments and additions thereto.

**27 Other Matters Denied**

All other matters requested in Permittee's application that are not specifically granted by this permit are denied.

**SOUTHERN TRINITY GROUNDWATER CONSERVATION DISTRICT  
COUNTY OF MCLENNAN, STATE OF TEXAS**

**THIS PERMIT IS ISSUED, EXECUTED THIS** 5 day of August, 2010, by the Board of Directors of the Southern Trinity Groundwater Conservation District.

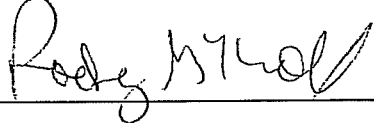

Rodney Kroll,  
President, Board of Directors

**ATTEST:**

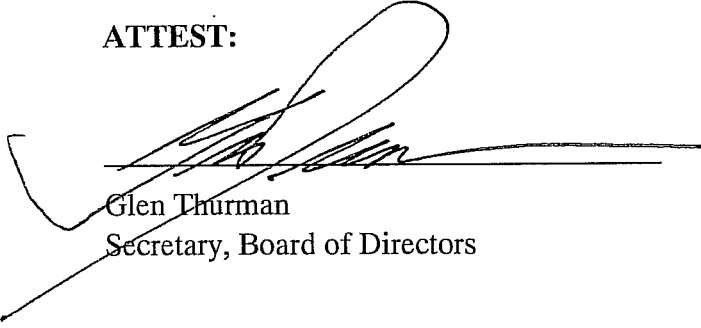
  
Glen Thurman  
Secretary, Board of Directors

**ACKNOWLEDGMENT**

STATE OF TEXAS )  
COUNTY OF MCLENNAN )

**ON BEHALF OF THE DISTRICT, THIS PERMIT WAS ACKNOWLEDGED** before me on August 5, 2010, by Rodney Kroll, President, Board of Directors, Southern Trinity Groundwater Conservation District, a groundwater conservation district created pursuant to Article XVI, Section 59, Texas Constitution.

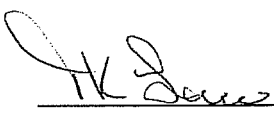

Notary Public in and for the State of Texas

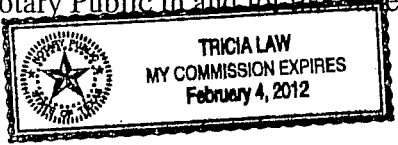

**AFTER RECORDING RETURN TO:**

Tricia Law, General Manager  
Southern Trinity Groundwater Conservation District  
P. O. Box 2205  
420 North 6th Street  
Waco, Texas 76703

**FILED AND RECORDED**

OFFICIAL PUBLIC RECORDS

*J.A. Andy Harwell*

August 06, 2010 01:03:59 PM

2010024366

FEE: \$27.00

J.A. "Andy" Harwell County Clerk

McLennan County TEXAS

McLennan County Clerk's Office  
2010024366  
August 06, 2010 01:03:59 PM  
FEE: \$27.00

**AFFIDAVIT**

**THE STATE OF TEXAS**  
**COUNTY OF MCLENNAN**

§  
§  
§

BEFORE ME, the undersigned authority, on this day personally appeared \_\_\_\_\_, who being duly sworn, upon oath deposes and says:

“My name is Scott Coleman. I am over 18 years of age, competent to make this affidavit, and am familiar with the facts herein stated and believe them to be true.

I have complied with the requirements of the Southern Trinity Groundwater Conservation District’s Rules to provide notification by first class mail to landowners, well owners and well operators within one half-mile of the well or wells for which I or the entity I represent seek(s) a Historic Use Production Permit. Such notification was made not less than 10 days before the public hearing scheduled to consider the application for a Historic Use Production Permit.”

*[Handwritten Signature]*

\_\_\_\_\_  
Affiant

Sworn to and subscribed before me on this 28<sup>th</sup> day of July, 2010.

*[Handwritten Signature]*  
\_\_\_\_\_  
Notary Public in and for the State of Texas

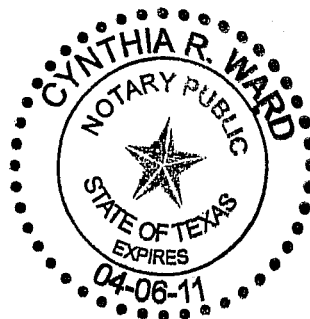

## **City of Bellmead**

**3015 Bellmead Dr**

**Bellmead TX 76705**

**Phone 254-799-2436 Fax 254-799-5969 email [scoleman@bellmead.com](mailto:scoleman@bellmead.com)**

July 28, 2010

Southern Trinity Groundwater District

PO Box 2205

Waco, TX 76703

Re: Application No. HUPP-2010-029

Please be advised that the City of Bellmead has determined that there are not any known water wells within ½ mile radius of the City of Bellmeads Wells. Attached is the affidavit required by STGCD.

Sincerely,

Scott Coleman

Director of Public works

City of Bellmead

**NOTICE OF PROPOSED HISTORIC USE PRODUCTION PERMITS  
AND PUBLIC HEARING**

The Southern Trinity Groundwater Conservation District ("District") proposes action on applications for Historic Use Production Permits ("HUPPs"), which would authorize the permittees to withdraw groundwater from the Trinity Aquifer according to the terms and conditions set forth in the permits. A copy of the general manager's proposed action, the proposed HUPPs and technical summaries are available for public inspection at the District's offices at 420 North 6<sup>th</sup> Street, Waco, Texas during regular business hours.

The District will conduct a public hearing pursuant to its authority under Chapter 8821 of the Texas Special District Local Laws Code, Chapter 36 of the Texas Water Code and the District's rules, to consider issuance of the proposed HUPPs and to provide interested members of the public the opportunity to appear and provide oral or written comments to the District regarding the proposed permits at the following date, time and place:

Date: Thursday, August 5, 2010  
Time: 9:00 a.m.  
Location: City of Woodway, City Council Chambers  
922 Estates Drive  
Woodway, Texas

HUPPs are proposed to be granted to the following entities as follows:

Spring Valley Water Supply Corporation, P.O. Box 399, Lorena, Texas, 76655 filed an application on 4/12/2010. The proposed HUPP has a maximum annual withdrawal of 62.5930 Acre-Feet (20,396,000 Gallons) for municipal use pumped from wells located at the following latitude/longitude (NAD83):N31D 39M 052S / W97D 30M 79S, N31D 41M 100S / W97D 25M 89S.

M.S. Water Supply Corporation, 510 N Memorial St., Riesel, Texas, 76682 filed an application on 4/14/2010. The proposed HUPP has a maximum annual withdrawal of 23.3051 Acre-Feet (7,594,000 Gallons) for municipal use pumped from wells located at the following latitude/longitude (NAD83):N31D 44.591/W097D 15.530.

Levi Water Supply Corporation, 2757 Rosenthal Pkwy, Lorena, Texas, 76655 filed an application on 4/16/2010. The proposed HUPP has a maximum annual withdrawal of 204.0709 Acre-Feet (66,496,700 Gallons) for municipal use pumped from wells located at the following latitude/longitude (NAD83):N31D 23M 19S / W97D 6M 51S, N31D 23M 33S / W97D 09M 44S, N31D 23M 21S / W97D 10M 24S.

City of Bruceville-Eddy, 143 Wilcox Dr., Eddy, Texas, 76524 filed an application on 4/26/2010. The proposed HUPP has a maximum annual withdrawal of 348.2604 Acre-Feet (113,481,000 Gallons) for municipal use pumped from wells located at the following latitude/longitude (NAD83):N31D 22M 2S / W97D 13M 29S, N31D 22M 2S / W97D 13M 28S, N31D 19M 2S / W97D 18M 22S, N31D 17M 47S / W97D 15M 13S.

Leroy-Tours-Gerald Water Supply Corporation, 312 W. Commerce, Leroy, Texas, 76654 filed an application on 4/29/2010. The proposed HUPP has a maximum annual withdrawal of 167.0067 Acre-Feet (54,419,300 Gallons) for municipal use pumped from



wells located at the following latitude/longitude (NAD83):N31D 43.851/W097 01.177, N31D 44M 13S / W97D 02M 33S, N31D 42M 27S / W97D 04M 11S.

City of Bellmead, 3015 Bellmead Dr., Bellmead, Texas, 76705 filed an application on 4/30/2010. The proposed HUPP has a maximum annual withdrawal of 1476.9910 Acre-Feet (481,279,000 Gallons) for municipal use pumped from wells located at the following latitude/longitude (NAD83):N31D 35M 45S / W97D 5 M 48S, N31D 36M 8S / W97D 05M 10S, N31D 37M 8S / W97D 05M 32S, N31D 35M 35S / W97D 06M 26S.

Pure Water Supply Corporation, P.O. Box 154414, Waco, Texas, 76715 filed an application on 4/30/2010. The proposed HUPP has a maximum annual withdrawal of 84.4251 Acre-Feet (27,510,000 Gallons) for municipal use pumped from wells located at the following latitude/longitude (NAD83):N31D 40.058/W097D 04.981, N31D 39.689/W097D 03.536.

City of Moody, 606 Ave. E., Moody, Texas, 76557 filed an application on 4/30/2010. The proposed HUPP has a maximum annual withdrawal of 61.5005 Acre-Feet (20,040,000 Gallons) for municipal use pumped from wells located at the following latitude/longitude (NAD83):N31D 18M 47S / W97D 21M 454S, N31D 18M 278S / W97D 21M 518S.

Ross Water Supply Corporation, P.O. Box 202, Ross, Texas, 76640 filed an application on 4/30/2010. The proposed HUPP has a maximum annual withdrawal of 256.4577 Acre-Feet (83,567,000 Gallons) for municipal use pumped from wells located at the following latitude/longitude (NAD83):N31D 43M 05S / W97D 07M 09S, N31D 43M 47S / W97D 05M 59S, N31D 42M 53S / W97D 07M 04S.

McLennan County WCID No. 2, P.O. Box 116, Elm Mott, Texas, 76640 filed an application on 5/3/2010. The proposed HUPP has a maximum annual withdrawal of 258.7532 Acre-Feet (84,315,000 Gallons) for municipal use pumped from wells located at the following latitude/longitude (NAD83):N31D 39M 75S / W97D 06M 26S, N31D 40M 43S / W97D 05M 36S, N31D 40M 50S / W97D 06M 32S.

EOL Water Supply Corporation, 9226 Elk Road, Axtell, Texas, 76624 filed an application on 5/3/2010. The proposed HUPP has a maximum annual withdrawal of 214.7877 Acre-Feet (69,988,800 Gallons) for municipal use pumped from wells located at the following latitude/longitude (NAD83):N31D 35M 18S / W96D 59M 08S, N31D 36M 55S / W96D 56M 13S, N31D 35M 36S / W96D 58M 28S.

Elm Creek Water Supply Corporation, P.O. Box 538, Moody, Texas, 76557 filed an application on 5/3/2010. The proposed HUPP has a maximum annual withdrawal of 225.3186 Acre-Feet (73,420,300 Gallons) for municipal use pumped from wells located at the following latitude/longitude (NAD83):N31D 17M 18S / W97D 18M 44S, N31D 19M 17S / W97D 23M 17S, N31D 15M 24S / W97D 47M 17S.

Patrick Water Supply Corporation, 245 Goldman Lane, Waco, Texas, 76708 filed an application on 5/3/2010. The proposed HUPP has a maximum annual withdrawal of 52.5578 Acre-Feet (17,126,000 Gallons) for municipal use pumped from wells located at the following latitude/longitude (NAD83):N31D 41M 09S / W97D 14M 78S.

Gholson Water Supply Corporation, 12520 Gholson Rd., Waco, Texas, 76705 filed an application on 5/3/2010. The proposed HUPP has a maximum annual withdrawal of 270.0348 Acre-Feet (87,991,100 Gallons) for municipal use pumped from wells located at the following latitude/longitude (NAD83):N31D .44.417./ W097D 15.223, N31D

43.851/ W097D 14.632, N31D 44.591/ W097D 15.530.

Hog Creek Water Supply Corporation, 147 Hsih Prairie Rd., Valley Mills, Texas, 76689 filed an application on 4/30/2010. The proposed HUPP has a maximum annual withdrawal of 81.5047 Acre-Feet (26,558,400 Gallons) for municipal use pumped from wells located at the following latitude/longitude (NAD83):N31D 36.880/W097D 31.806, N31D 29.799/W096D 58.105.

City of West, 110 N Reagan St., West, Texas, 76691 filed an application on 3/10/2010. The proposed HUPP has a maximum annual withdrawal of 465.3691 Acre-Feet (151,641,000 Gallons) for municipal use pumped from wells located at the following latitude/longitude (NAD83):N31D 48M 58S / W97D 05M 33S.

HUPP applicants or affected persons may file a written request for a contested case hearing on the proposed HUPPs with the District by no later than August 2, 2010 at 9:00 a.m. If no timely requests for contested case hearing are filed, the applications will be presented to the District on the date of the hearing for final action.

**ISSUED THIS 16th DAY OF July 2010.**

---

Tricia K. Law, General Manager  
Southern Trinity Groundwater Conservation District

May 11, 2010

Southern Trinity Groundwater Conservation District  
P.O. Box 2205  
420 North 6<sup>th</sup> street  
Waco TX 76703

To whom it may concern,

As requested, I have re-submitted a corrected version of part A of the Southern Trinity Groundwater Association HUPP application for the City of Bellmead.

Thank you,

Scott Coleman  
Public Works Director  
City Of Bellmead  
3015 Bellmead Dr  
Bellmead, TX, 76705



**SOUTHERN TRINITY GROUNDWATER CONSERVATION DISTRICT**

P. O. Box 2205  
 420 North 6th Street  
 Waco, Texas 76703

Phone: (254) 759-5610 [southerntrinitygcd@att.net](mailto:southerntrinitygcd@att.net)

**APPLICATION FOR HISTORIC USE PRODUCTION PERMIT**

**Part A – General Information**

**Instructions:** Please type or print legibly. Incomplete applications will not be accepted. Application Fee Required: A non-refundable application fee of \$1,000 must accompany this application. Only checks or money orders made payable to “Southern Trinity Groundwater Conservation District” will be accepted. **CASH IS NOT ACCEPTED.**

1. Applicant Information		
<input type="checkbox"/> Individual	<input type="checkbox"/> Partnership	<input type="checkbox"/> Corporation
<input checked="" type="checkbox"/> Government Entity	<input type="checkbox"/> Estate/Trust/Guardianship	
Permit Applicant's Name: City of Bellmead		
Physical Address: 3015 Bellmead Dr		
City: Bellmead	State: Tx	Zip Code: 76705
Mailing Address, (if different):		
City:	State:	Zip Code:
Daytime Telephone Number:    Fax: 254-799-2436, Fax 254-799-5969		
Email Address (if any):		
2. Name of Authorized Agent (if any): Scott Coleman		
Position: Public Works Director		
Physical Address: 3015 Bellmead Dr		
City: Bellmead	State: Tx	Zip Code: 76705
Mailing Address (if different):		
City:	State:	Zip Code:
Daytime Telephone Numbers of Authorized Agent: 254-799-2436    Fax: 254-799-5969		
Email for Authorized Agent (if any): scoleman@bellmead.com		
<div style="border: 2px solid black; padding: 5px; display: inline-block;"> <b>RECEIVED</b>  <i>District Use Only</i>                  Date Application Received: <u>MAY 17 2010</u>    Date Admin. Fee Received: _____    Amount of Fee: _____                  BY: <u>[Signature]</u> </div>		

**Historic Groundwater Use and Production Information.**

3. Purpose of Historic Use: The purpose(s) for which the groundwater was used during the Historic Use Period.  Irrigation  Municipal  Industrial  
 Other (If Other, describe specifically):

4. Purpose of Future Use: Municipal

5. Is the place of use within the District boundaries:  Yes  No

6. If you answered No to Item 5, has a groundwater exportation permit been applied for or obtained from the District or is there a groundwater export agreement or contract in effect prior to January 7, 2010?  Yes  No

7. If you answered Yes to Item 6, please describe the parties to the agreement, the location outside of the District that the water is used, the amount use, and pipeline route.  
 N/A

8. Completely describe the place of use of groundwater withdrawn from the well:  
 City of Bellmead Public Water Supply

9. If groundwater was withdrawn from the well or placed to a beneficial use by a contract user or predecessor in interest, then provide the name, address, and telephone number of each contract user or predecessor in interest, and provide copies of the legal documents establishing the legal right of the contract user or predecessor in interest to withdraw and/or place groundwater from the well to beneficial use.

N/A

10. If applicable, provide a copy of the map identifying the boundaries of the applicant's Certificate of Convenience and Necessity (CCN).

11. If applicable, describe the number of connections to be serviced by the well: 3300

12. Maximum Historic Use. State the amount of water that you claim as your Maximum Historic Use during any one year of the Historic Use Period. Maximum Historic Use means the maximum amount of groundwater that an applicant for a Historic Use Production Permit proves was produced and beneficially used without waste from the applicant's non-exempt well during any one calendar year of the Historic Use Period.

Amount: 481,279,000

Units: Million Gal

Year:2000

13. Provide your use amounts for each year groundwater was withdrawn during the Historical Use Period. If no groundwater was withdrawn for a period listed below, place a zero (0) in the appropriate space (typical units are in gallons, 100 gallons, 1000 gallons, or acre-feet).

2009	Amount: 466,946,000	Units: Million Gal
2008	Amount: 473,469,000	Units: Million Gal
2007	Amount: 415,722,000	Units: Million Gal
2006	Amount: 465,114,000	Units: Million Gal
2005	Amount: 445,284,000	Units: Million Gal
2004	Amount: 393,346,000	Units: Million Gal
2003	Amount: Missing Records	Units: Million Gal
2002	Amount: Missing Records	Units: Million Gal
2001	Amount: Missing Records	Units: Million Gal
2000	Amount: 481,279,000	Units: Million Gal

14. Attach documents to substantiate your claim of Maximum Historic Use. Documentation may include, but is not limited to: production logs showing amount of water pumped, copies of reports to the Texas Commission on Environmental Quality, the Texas Water Development Board, or the Texas Department of Health; reports filed with or created by the Natural Resource Conservation Service or Farm Services Agency or aerial photographs; reports filled with or created by soil and water conservation districts; fuel and electricity use records; and calculations used to estimate well discharge rates if the well discharge is not metered. The purpose of supporting documentation is to substantiate your declaration. The information you provide should be labeled, indexed and in a form that can be easily reviewed by the District.

15. Will the proposed use of water unreasonably affect existing groundwater and surface water resources or existing permit holders?  Yes  No

16. Is the proposed use of water dedicated to a beneficial use?  Yes  No

17. Is the proposed use of water consistent with the District's management plan?  Yes  No

**STATEMENT OF COMPLIANCE WITH DISTRICT GROUNDWATER  
MANAGEMENT PLAN, DISTRICT RULES, AND COMMITMENT TO WATER  
CONSERVATION AND WATER QUALITY PROTECTION**

Please check all that apply:

- Applicant will comply with the District's Groundwater Management Plan.
- Applicant is in compliance with all applicable District rules in effect since December 7, 2007 and will comply with the District's rules.
- Applicant agrees to avoid waste and achieve water conservation.
- Applicant agrees to use reasonable diligence to protect groundwater quality and will follow the District's well plugging guidelines at the time of well closure.
- Applicant affirms that activities constituting the purpose of use for which the groundwater will be beneficially used will be managed to preserve, protect, prevent the pollution, degradation, or harmful alteration of, control and prevent the waste of, prevent the escape of groundwater from, and achieve the conservation of groundwater in and produced from, the aquifer.

**CERTIFICATION†**

I, the undersigned applicant, subscribe and affirm that the information provided herein is true and correct. I also understand that it shall be considered to be a fraud upon the District for any applicant to knowingly give erroneous information in this application.

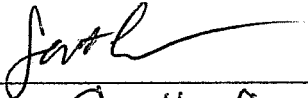
Signed:   
Printed Name: Scott Coleman

Date: 5-11-10  
Title: Public Works Director

† If the applicant is an individual, the application shall be signed by the applicant or a duly appointed agent. An agent shall provide written evidence of his or her authority to represent the applicant. If the applicant is an individual doing business under an assumed name, the applicant shall attach to the application an assumed name certificate filed with the county clerk of the county in which the principal place of business is located or with the Texas Secretary of State.

A joint application shall be signed by each applicant or each applicant's duly authorized agent with written evidence of such agency submitted with the application. If a well or proposed well is owned by both husband and wife, each person shall sign the application. Joint applicants shall select one among them to act for and represent the others in pursuing the application with the District with written evidence of such representation to be submitted with the application.

If the application is by a partnership, the application shall be signed by one of the general partners. If the applicant is a partnership doing business under an assumed name, the applicant shall attach to the application an assumed name certificate filed with the county clerk of the county in which the principal place of business is located or with the Texas Secretary of State. The name of the partnership must be followed by the words "a partnership." If the applicant is an estate or guardianship, the application shall be signed by the duly appointed guardian or representative of the estate and a current copy of the letters testamentary issued by the court shall be attached to the application.

If the applicant is a corporation, public district, county, municipality or other corporate entity, the application shall be signed by a duly authorized official. Written evidence in the form of bylaws, charters, or resolutions specifying the authority of the official to take such action shall be submitted along with the application. A corporation may file a corporate affidavit as evidence of a corporate official's authority to sign.

If the applicant is acting as trustee for another, the applicant shall sign as trustee and in the application shall disclose the nature of the trust agreement and give the name and current address of each trust beneficiary. The application must designate the trustee's name followed by the word "trustee," and the name of the trust for which the trustee is acting.





May 10, 2010

Called Scott Coleman, Public Works Director with the City of Bellmead at 10:05 am.  
Asked Mr. Coleman to re-submit Part A. He said he would get it in within the week.

Tricia K. Law

A handwritten signature in black ink, appearing to read "Tricia K. Law", written over the printed name.

## Southern Trinity GCD

---

**From:** awblair [awblair@awblair.com]

**Sent:** Tuesday, May 04, 2010 3:57 PM

**To:** 'Southern Trinity GCD'

**Subject:** Multiple Form A

I check the rules, and it is clear that HUPP is for all production from a given aquifer for a given entity. We need to return the multiple Forms and ask for a single form.

**SOUTHERN TRINITY GROUNDWATER CONSERVATION DISTRICT**

P. O. Box 2205  
 420 North 6th Street  
 Waco, Texas 76703

Phone: (254) 759-5610 [southerntrinitygcd@att.net](mailto:southerntrinitygcd@att.net)

**APPLICATION FOR HISTORIC USE PRODUCTION PERMIT**

**Part A – General Information**

**Instructions:** Please type or print legibly. Incomplete applications will not be accepted. Application Fee Required: A non-refundable application fee of \$1,000 must accompany this application. Only checks or money orders made payable to “Southern Trinity Groundwater Conservation District” will be accepted. **CASH IS NOT ACCEPTED.**

1. Applicant Information	<input type="checkbox"/> Individual	<input type="checkbox"/> Partnership	<input type="checkbox"/> Corporation
	<input checked="" type="checkbox"/> Government Entity	<input type="checkbox"/> Estate/Trust/Guardianship	
Permit Applicant's Name: City of Bellmead			
Physical Address: 3015 Bellmead Dr			
City: Bellmead	State: Tx	Zip Code: 76705	
Mailing Address, (if different):			
City:	State:	Zip Code:	
Daytime Telephone Number: <del>Fax: 254-799-2436</del> , Fax 254-799-5969			
Email Address (if any): <u>cell</u>			
2. Name of Authorized Agent (if any): Scott Coleman			
Position: Public Works Director			
Physical Address: 3015 Bellmead Dr			
City: Bellmead	State: Tx	Zip Code: 76705	
Mailing Address (if different):			
City:	State:	Zip Code:	
Daytime Telephone Numbers of Authorized Agent: 254-799-2436 Fax: 254-799-5969			
Email for Authorized Agent: <u>scoleman@bellmead.com</u>			
Date Application Received:		Date Admin. Fee Received:	
APR 30 2010		Amount of Fee:	
BY: <u>[Signature]</u>			

**RECEIVED**  
 APR 30 2010  
 BY: [Signature]

*For District Use Only*

✓

**Historic Groundwater Use and Production Information.**

3. Purpose of Historic Use: The purpose(s) for which the groundwater was used during the Historic Use Period.  Irrigation  Municipal  Industrial  
 Other (If Other, describe specifically):

4. Purpose of Future Use: Municipal

5. Is the place of use within the District boundaries:  Yes  No

6. If you answered No to Item 5, has a groundwater exportation permit been applied for or obtained from the District or is there a groundwater export agreement or contract in effect prior to January 7, 2010?  Yes  No *N/A*

7. If you answered Yes to Item 6, please describe the parties to the agreement, the location outside of the District that the water is used, the amount use, and pipeline route.  
*N/A*

8. Completely describe the place of use of groundwater withdrawn from the well:  
 City of Bellmead Public Water Supply

9. If groundwater was withdrawn from the well or placed to a beneficial use by a contract user or predecessor in interest, then provide the name, address, and telephone number of each contract user or predecessor in interest, and provide copies of the legal documents establishing the legal right of the contract user or predecessor in interest to withdraw and/or place groundwater from the well to beneficial use.

*N/A*

10. If applicable, provide a copy of the map identifying the boundaries of the applicant's Certificate of Convenience and Necessity (CCN).

11. If applicable, describe the number of connections to be serviced by the well: 3300

12. Maximum Historic Use. State the amount of water that you claim as your Maximum Historic Use during any one year of the Historic Use Period. Maximum Historic Use means the maximum amount of groundwater that an applicant for a Historic Use Production Permit proves was produced and beneficially used without waste from the applicant's non-exempt well during any one calendar year of the Historic Use Period.

Amount: 124,009,000

Units: Million Gal

Year: 2008

13. Provide your use amounts for each year groundwater was withdrawn during the Historical Use Period. If no groundwater was withdrawn for a period listed below, place a zero (0) in the appropriate space (typical units are in gallons, 100 gallons, 1000 gallons, or acre-feet).

2009	Amount: 109,959,000	Units: Million Gal
2008	Amount: 124,009,000	Units: Million Gal
2007	Amount: 81,005,000	Units: Million Gal
2006	Amount: 103,112,000	Units: Million Gal
2005	Amount: 108,836,000	Units: Million Gal
2004	Amount: 102,219,000	Units: Million Gal
2003	Amount: Missing Records	Units: Million Gal
2002	Amount: Missing Records	Units: Million Gal
2001	Amount: Missing Records	Units: Million Gal
2000	Amount: 85,810,000	Units: Million Gal

14. Attach documents to substantiate your claim of Maximum Historic Use.

Documentation may include, but is not limited to: production logs showing amount of water pumped, copies of reports to the Texas Commission on Environmental Quality, the Texas Water Development Board, or the Texas Department of Health; reports filed with or created by the Natural Resource Conservation Service or Farm Services Agency or aerial photographs; reports filled with or created by soil and water conservation districts; fuel and electricity use records; and calculations used to estimate well discharge rates if the well discharge is not metered. The purpose of supporting documentation is to substantiate your declaration. The information you provide should be labeled, indexed and in a form that can be easily reviewed by the District.

15. Will the proposed use of water unreasonably affect existing groundwater and surface water resources or existing permit holders?  Yes  No

16. Is the proposed use of water dedicated to a beneficial use?  Yes  No

17. Is the proposed use of water consistent with the District's management plan?  Yes  No

**STATEMENT OF COMPLIANCE WITH DISTRICT GROUNDWATER MANAGEMENT PLAN, DISTRICT RULES, AND COMMITMENT TO WATER CONSERVATION AND WATER QUALITY PROTECTION**

Please check all that apply:

- Applicant will comply with the District's Groundwater Management Plan.
- Applicant is in compliance with all applicable District rules in effect since December 7, 2007 and will comply with the District's rules.
- Applicant agrees to avoid waste and achieve water conservation.
- Applicant agrees to use reasonable diligence to protect groundwater quality and will follow the District's well plugging guidelines at the time of well closure.
- Applicant affirms that activities constituting the purpose of use for which the groundwater will be beneficially used will be managed to preserve, protect, prevent the pollution, degradation, or harmful alteration of, control and prevent the waste of, prevent the escape of groundwater from, and achieve the conservation of groundwater in and produced from, the aquifer.

**CERTIFICATION†**

I, the undersigned applicant, subscribe and affirm that the information provided herein is true and correct. I also understand that it shall be considered to be a fraud upon the District for any applicant to knowingly give erroneous information in this application.

Signed:                     *Scott Coleman*                      
Printed Name:                     Scott Coleman                    

Date:                     4-15-10                      
Title:                     Public Works Director                    

† If the applicant is an individual, the application shall be signed by the applicant or a duly appointed agent. An agent shall provide written evidence of his or her authority to represent the applicant. If the applicant is an individual doing business under an assumed name, the applicant shall attach to the application an assumed name certificate filed with the county clerk of the county in which the principal place of business is located or with the Texas Secretary of State.

A joint application shall be signed by each applicant or each applicant's duly authorized agent with written evidence of such agency submitted with the application. If a well or proposed well is owned by both husband and wife, each person shall sign the application. Joint applicants shall select one among them to act for and represent the others in pursuing the application with the District with written evidence of such representation to be submitted with the application.

If the application is by a partnership, the application shall be signed by one of the general partners. If the applicant is a partnership doing business under an assumed name, the applicant shall attach to the application an assumed name certificate filed with the county clerk of the county in which the principal place of business is located or with the Texas Secretary of State. The name of the partnership must be followed by the words "a partnership." If the applicant is an estate or guardianship, the application shall be signed by the duly appointed guardian or representative of the estate and a current copy of the letters testamentary issued by the court shall be attached to the application.

If the applicant is a corporation, public district, county, municipality or other corporate entity, the application shall be signed by a duly authorized official. Written evidence in the form of bylaws, charters, or resolutions specifying the authority of the official to take such action shall be submitted along with the application. A corporation may file a corporate affidavit as evidence of a corporate official's authority to sign.

If the applicant is acting as trustee for another, the applicant shall sign as trustee and in the application shall disclose the nature of the trust agreement and give the name and current address of each trust beneficiary. The application must designate the trustee's name followed by the word "trustee," and the name of the trust for which the trustee is acting.



**STGWCD- HUPP Application - Part B – Well Information (one form per well)**

1. Applicant Name: City of Bellmead			
2. Well Identifier or Well Name: Barlow #2			
3. System Name: City of Bellmead			
4. TCEQ System ID Number: 1550001			
5. If applicable, please attach a copy of the applicant's most recent water conservation plan and drought contingency plan prepared for TCEQ.			
6. TWDB ID Number: 403103			
7. Aquifer(s) or formations in which the well is screened: Trinity			
8. Address of the property upon which the well is located: 3709 Hatcher St			
9. Well Location:	Latitude:	31 D	35 M 45.063 S
	Longitude:	-97 D	5 M 48.0222 S
10. Identify any surface water, including lakes or rivers within 1,000 feet of the well: N/A			
11. Well or Driller's Log. Please attach a copy of the State Well Report and, if available, any geophysical logs for the well.			
12. Please attach a photograph of the well taken approximately 100 feet from the well.			
13. Please attach a copy of a recorded deed or other legal document verifying the applicant's ownership of the well. Disregard this requirement if the deed was sent with your Application for Interim Production Status and there has been no change.			
14. Year well drilled: 1957 Year well completed and operational: 1957			
15. Pump Information: Pump Make and Model: Centrilift HC20000			
Pump power source: <input checked="" type="checkbox"/> Electric <input type="checkbox"/> Diesel <input type="checkbox"/> Natural Gas <input type="checkbox"/> Other			
Casing Material <input checked="" type="checkbox"/> Steel <input type="checkbox"/> PVC			
Size of well casing: 20,16,8 inches Inside diameter of column pipe: 6,4 inches			
16. The maximum rate at which water can be withdrawn from the well: gpm			
17. Flow Meter Make and Model: Sensus Propeller 300			
Serial Number: 51494		Meter Units: Gal 1000	
Meter reading end of 2008: Amount: 549598		Units: Gal 1000	Date: 12-31-08
Meter reading end of 2009: Amount: 659557		Units: Gal 1000	Date: 12-31-09



Barlow Well

**TWDB GROUNDWATER DATA (Explanation)**

Rec	OBJECT	State Well Number	Owner	Water Use	Elevation	Well Depth	Water Level	Water Quality	Aquifer Code	Latitude	Longitude	COUNTY_CODE	WELL_TYPI
1	48595424	4032103	City of Bellmead	P	440	2396	P	Y	217HSTN	313546	970544	309	W



C-210

LAKES

32

804

704 702

701

LAKESVIEW

801

802

104

106

505

Povrish Barlow

WELLHEAD

201

501 502

612

601

613

503 504

602

403

404

604 608

605

603

606

609

610

501

502

609

605

610

901

902

903

904

901

902

901

901

MC LENNAN COUNTY

Table 1. -- Records of Selected Water Wells -- Continued

WELL	OWNER	DRILLER	DATE COMPLETED	DEPTH OF WELL (ft)	CASTING		WATER BEARING UNIT	ALTITUDE OF LAND SURFACE (ft)	ABOVE (+) OR BELOW (-) SURFACE DATUM (ft)	WATER LEVEL		METHOD OF LIFT	USE OF WATER	REMARKS
					DIAM-ETER (in.)	DEPTH (ft)				DATE OF MEASUREMENT	MEASUREMENT			
* 87-40-31-901	City of Waco	Swart Hout Bros.	1948	1,560	--	--	Khe	495	--	--	T, E 20	P	Abandoned. <u>y</u>	
* 902	do.	Fowler Construction	--	2,410	--	--	Ktp	500	+138	1913	N	N	Perforated from 2,200 to 2,400 ft. Pump set at 415 ft. Reported yield 165 gpm. Temp. 87°F. <u>y</u>	
* 32-101	City of Bellmead	J. L. Myers Sons	1949	2,400	10	29	Kho	445	--	--	T, E 75	P	Slotted from 2,115 to 2,287 ft. Pumping level 222 ft at 400 gpm on June 27, 1948. Pump set at 800 ft. Reported yield 500 gpm. Cemented from 2,115 ft to surface. Temp. 116°F. <u>y</u>	
* 102	5740 do. 32-102	Layne Texas Co.	1948	2,303	5	702	do.	435	+	June 15, 1948 June 9, 1949 June 9, 1962	T, E 75	P	Slotted from 2,198 to 2,392 ft. Pumping level 381 ft at 615 gpm on May 23, 1957. Pump set at 520 ft. Cemented from 2,198 ft to surface. Temp. 115°F. <u>y</u>	
* 103	5740 do. 32-103	J. L. Myers Sons	1957	2,396	20	53	do.	440	160	May 21, 1957 Dec. 1960 Dec. 1962 Apr. 1964 May 31, 1965 Oct. 10, 1967	T, E 175	P	Slotted from 2,153 to 2,320 ft. Pumping level 454 ft at 500 gpm on Dec. 13, 1960. Pump set at 650 ft. Cemented from 2,153 ft to surface. <u>y</u>	
* 104	City of Lacy - Lakeview	J. L. Myers Sons	1960	2,329	20	40	Kho	478	250	Dec. 13, 1960 Mar. 1964	Sub, E 100	P	Slotted from 2,110 to 2,311 ft. Pumping level 357 ft at 726 gpm on July 22, 1944. Pump set at 490 ft. Reported yield 750 gpm. Cemented from 697 ft to surface. Temp. 115°F. <u>y</u>	
* 106	Plantation Foods, Inc.	Smith and Bra shaw Pump Co.	1965	2,255	--	--	Ktp	440	--	--	--	Ind	Perforated. <u>y</u>	
* 201	Frank B. Tlsey	J. L. Myers Sons	1951	2,511	6	617	do.	440	--	--	--	D, S	Slotted from 2,110 to 2,311 ft. Pumping level 357 ft at 726 gpm on July 22, 1944. Pump set at 490 ft. Reported yield 750 gpm. Cemented from 697 ft to surface. Temp. 115°F. <u>y</u>	
* 403	General Tire and Rubber Co.	Layne Texas Co.	1944	2,312	16	697	Kho	407	+30	July 18, 1944 1960 June 22, 1964	Sub, E 100	Ind	Slotted from 2,110 to 2,311 ft. Pumping level 357 ft at 726 gpm on July 22, 1944. Pump set at 490 ft. Reported yield 750 gpm. Cemented from 697 ft to surface. Temp. 115°F. <u>y</u>	
* 404	do.	do.	1945	2,376	16	726	do.	405	+30	1949 2,138 2,374	T, E 125	Ind	Slotted from 2,110 to 2,311 ft. Pumping level 357 ft at 726 gpm on July 22, 1944. Pump set at 490 ft. Reported yield 750 gpm. Cemented from 697 ft to surface. Temp. 115°F. <u>y</u>	
* 405	Texas Power and Light Co.	Hill, Green, Dearing and Son	1914	2,147	8	769	Ktp	387	89	1914 1949	T, E 30	Ind	Slotted from 2,110 to 2,311 ft. Pumping level 357 ft at 726 gpm on July 22, 1944. Pump set at 490 ft. Reported yield 750 gpm. Cemented from 697 ft to surface. Temp. 115°F. <u>y</u>	
* 501	City of Waco	J. L. Myers Sons	1958	2,493	16	53	Kho	445	193	July 17, 1958 Apr. 3, 1969	Sub, E 40	P	Slotted from 2,110 to 2,311 ft. Pumping level 357 ft at 726 gpm on July 22, 1944. Pump set at 490 ft. Reported yield 750 gpm. Cemented from 697 ft to surface. Temp. 115°F. <u>y</u>	
* 502	do.	do.	1949	2,500	10	40	do.	460	--	--	N	N	Slotted from 2,337 to 2,500 ft. Well plugged. <u>y</u>	
* 37-301	City of McGregor	Harvey Meadows and Son Well Driller	1965	1,340	10	970	Kha	739	400	Apr. 29, 1965 Mar. 7, 1969	Sub, E 75	P	Completed from 980 to 1,050 ft. Pumping level 597 ft at 155 gpm on Mar. 11, 1965. Pump set at 700 ft. Reported yield 220 gpm. Cemented from 970 ft to surface. Texas Water Development Board observation well. <u>y</u>	
* 601	do.	-- Darley	1908	1,028	12	--	do.	690	190	1943 1962	T, E 50	P	Pump set at 500 ft. Reported yield 250 gpm. Temp. 85°F. <u>y</u>	
* 602	do.	Layne Texas Co.	1942	1,250	8	977	Khe, Kpe	690	175	Aug. 31, 1942	N	N	Completed from 975 to 1,045, 1,045 to 1,066 and 1,136 to 1,180 ft. Pumping level 565 ft at 275 gpm in May 1959. Reported yield 50 gpm. Well plugged and abandoned. <u>y</u>	

Parrish  
Barlow

See footnotes at end of table.

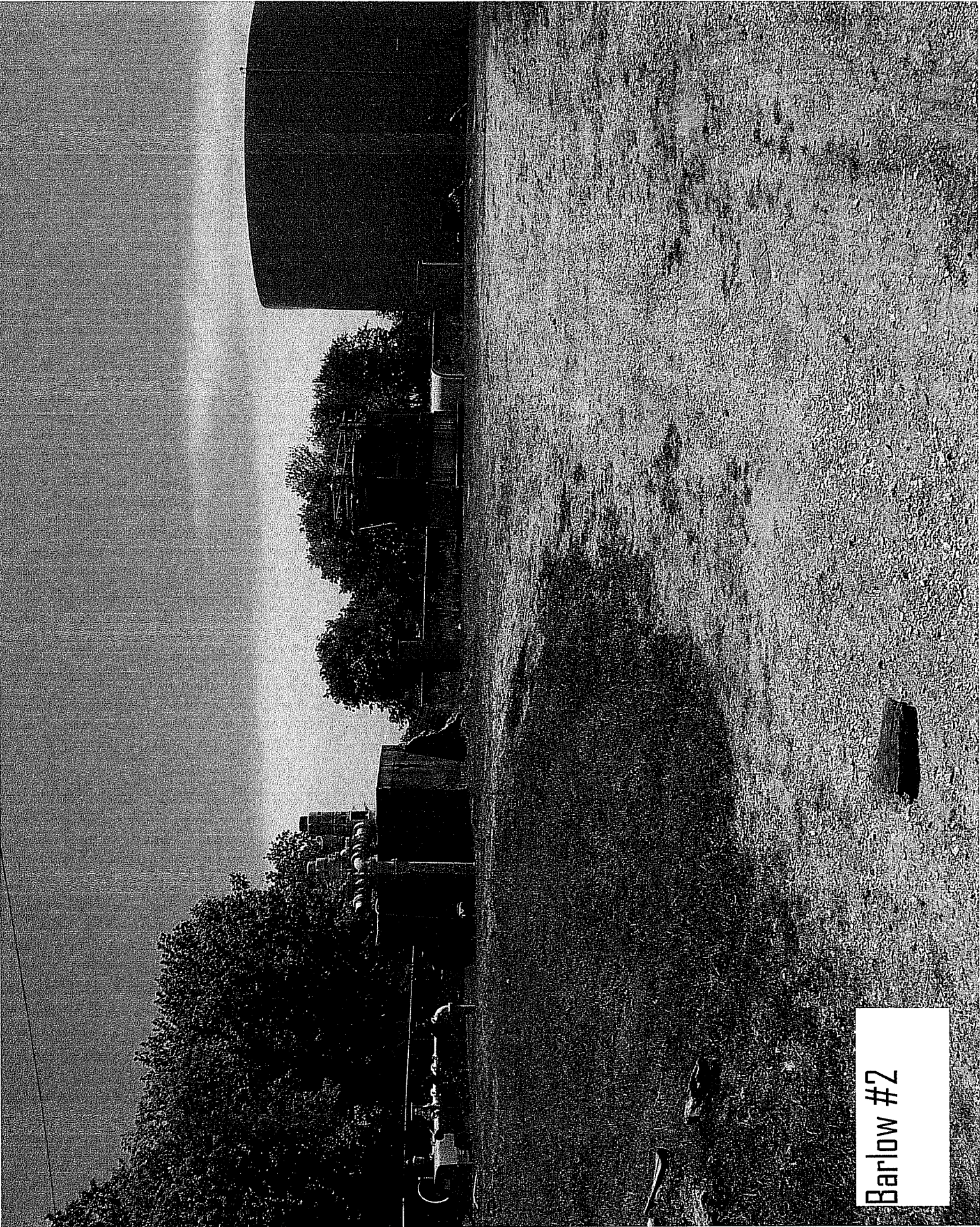

Barlow #2

**SOUTHERN TRINITY GROUNDWATER CONSERVATION DISTRICT**

P. O. Box 2205  
 420 North 6th Street  
 Waco, Texas 76703

Phone: (254) 759-5610 [southerntrinitygcd@att.net](mailto:southerntrinitygcd@att.net)

**APPLICATION FOR HISTORIC USE PRODUCTION PERMIT**

**Part A – General Information**

**Instructions:** Please type or print legibly. Incomplete applications will not be accepted. Application Fee Required: A non-refundable application fee of \$1,000 must accompany this application. Only checks or money orders made payable to “Southern Trinity Groundwater Conservation District” will be accepted. **CASH IS NOT ACCEPTED.**

1. Applicant Information		
<input checked="" type="checkbox"/> Individual	<input type="checkbox"/> Partnership	<input type="checkbox"/> Corporation
<input type="checkbox"/> Government Entity	<input type="checkbox"/> Estate/Trust/Guardianship	
Permit Applicant's Name: City of Bellmead		
Physical Address: 3015 Bellmead Dr		
City: Bellmead	State: Tx	Zip Code: 76705
Mailing Address, (if different):		
City:	State:	Zip Code:
Daytime Telephone Number: <del>Fax: 254-799-2436</del> Fax: 254-799-5969		
Email Address (if any): scoleman@bellmead.com		
2. Name of Authorized Agent (if any): Scott Coleman		
Position: Public Works Director		
Physical Address: 3015 Bellmead Dr		
City: Bellmead	State: Tx	Zip Code: 76705
Mailing Address (if different):		
City:	State:	Zip Code:
Daytime Telephone Numbers of Authorized Agent: 254-799-2436 Fax: 254-799-5969		
Email for Authorized Agent (if any): Scoleman@bellmead.com		
<div style="border: 1px solid black; padding: 5px; display: inline-block;"> <p><b>RECEIVED</b></p> <p>APR 30 2010</p> <p><i>For District Use Only</i></p> </div>		
Date Application Received:	Date Admin. Fee Received:	Amount of Fee:
BY: <u>[Signature]</u>		



**Historic Groundwater Use and Production Information.**

3. Purpose of Historic Use: The purpose(s) for which the groundwater was used during the Historic Use Period.  Irrigation  Municipal  Industrial  
 Other (If Other, describe specifically):

4. Purpose of Future Use: Municipal

5. Is the place of use within the District boundaries:  Yes  No

6. If you answered No to Item 5, has a groundwater exportation permit been applied for or obtained from the District or is there a groundwater export agreement or contract in effect prior to January 7, 2010?  Yes  No *N/A*

7. If you answered Yes to Item 6, please describe the parties to the agreement, the location outside of the District that the water is used, the amount use, and pipeline route.  
*N/A*

8. Completely describe the place of use of groundwater withdrawn from the well:  
*City of Bellmead Public Water Supply*

9. If groundwater was withdrawn from the well or placed to a beneficial use by a contract user or predecessor in interest, then provide the name, address, and telephone number of each contract user or predecessor in interest, and provide copies of the legal documents establishing the legal right of the contract user or predecessor in interest to withdraw and/or place groundwater from the well to beneficial use.

*N/A*

10. If applicable, provide a copy of the map identifying the boundaries of the applicant's Certificate of Convenience and Necessity (CCN).

11. If applicable, describe the number of connections to be serviced by the well: *3300*

12. Maximum Historic Use. State the amount of water that you claim as your Maximum Historic Use during any one year of the Historic Use Period. Maximum Historic Use means the maximum amount of groundwater that an applicant for a Historic Use Production Permit proves was produced and beneficially used without waste from the applicant's non-exempt well during any one calendar year of the Historic Use Period.

Amount: *132,797,000*

Units: *Million Gal*

Year: *2006*

13. Provide your use amounts for each year groundwater was withdrawn during the Historical Use Period. If no groundwater was withdrawn for a period listed below, place a zero (0) in the appropriate space (typical units are in gallons, 100 gallons, 1000 gallons, or acre-feet).

2009	Amount: 111,732,000	Units: Million Gal
2008	Amount: 121,587,000	Units: Million Gal
2007	Amount: 54,361,000	Units: Million Gal
2006	Amount: 132,797,000	Units: Million Gal
2005	Amount: 125,809,000	Units: Million Gal
2004	Amount: 125,037,000	Units: Million Gal
2003	Amount: Missing Records	Units: Million Gal
2002	Amount: Missing Records	Units: Million Gal
2001	Amount: Missing Records	Units: Million Gal
2000	Amount: 126,841,000	Units: Million Gal

14. Attach documents to substantiate your claim of Maximum Historic Use. Documentation may include, but is not limited to: production logs showing amount of water pumped, copies of reports to the Texas Commission on Environmental Quality, the Texas Water Development Board, or the Texas Department of Health; reports filed with or created by the Natural Resource Conservation Service or Farm Services Agency or aerial photographs; reports filled with or created by soil and water conservation districts; fuel and electricity use records; and calculations used to estimate well discharge rates if the well discharge is not metered. The purpose of supporting documentation is to substantiate your declaration. The information you provide should be labeled, indexed and in a form that can be easily reviewed by the District.

15. Will the proposed use of water unreasonably affect existing groundwater and surface water resources or existing permit holders?  Yes  No

16. Is the proposed use of water dedicated to a beneficial use?  Yes  No

17. Is the proposed use of water consistent with the District's management plan?  Yes  No







**STGWCD- HUPP Application - Part B – Well Information (one form per well)**

1. Applicant Name: City of Bellmead			
2. Well Identifier or Well Name: Concord			
3. System Name: City of Bellmead			
4. TCEQ System ID Number: 1550001			
5. If applicable, please attach a copy of the applicant's most recent water conservation plan and drought contingency plan prepared for TCEQ.			
6. TWDB ID Number: 4032202			
7. Aquifer(s) or formations in which the well is screened: Trinity			
8. Address of the property upon which the well is located: 4505 Concord			
9. Well Location:	Latitude:	31 D	36 M 8.499 S
	Longitude:	-97 D	5 M 10.446 S
10. Identify any surface water, including lakes or rivers within 1,000 feet of the well: N/A			
11. Well or Driller's Log. Please attach a copy of the State Well Report and, if available, any geophysical logs for the well.			
12. Please attach a photograph of the well taken approximately 100 feet from the well.			
13. Please attach a copy of a recorded deed or other legal document verifying the applicant's ownership of the well. Disregard this requirement if the deed was sent with your Application for Interim Production Status and there has been no change.			
14. Year well drilled: 1978 Year well completed and operational: 1978			
15. Pump Information: Pump Make and Model: Byron Jackson 11mql-16 stage			
Pump power source: <input checked="" type="checkbox"/> Electric <input type="checkbox"/> Diesel <input type="checkbox"/> Natural Gas <input type="checkbox"/> Other			
Casing Material <input checked="" type="checkbox"/> Steel <input type="checkbox"/> PVC			
Size of well casing: 26,16,7 inches Inside diameter of column pipe: 8 inches			
16. The maximum rate at which water can be withdrawn from the well: 700 gpm			
17. Flow Meter Make and Model: Sensus Propeller-300			
Serial Number: 49942		Meter Units: Gal 1000	
Meter reading end of 2008: Amount: 617613		Units: Gal 1000	Date: 12-31-08
Meter reading end of 2009: Amount: 729345		Units: Gal 1000	Date: 12-31-09

Colcord Well

**TWDB GROUNDWATER DATA (Explanation)**

Rec	OBJECT	State Well Number	Owner	Water Use	Elevation	Well Depth	Water Level	Water Quality	Aquifer Code	Latitude	Longitude	COUNTY_CODE	WELL_TYP
1	48595430	4032202	City of Bellmead	P	470	2464	P	Y	217HSTN	313629	970456	309	W

J. L. MYERS COMPANY  
DALLAS

DRILLERS LOG

OWNER: CITY OF BELLMEAD

LOCATION: WELL #3, CONCORD ROAD APPROXIMATELY ½ MILE NORTHEAST  
OF U. S. HIGHWAY 84 AND FR2418, MCLENNAN COUNTY, TEXAS

DRILLED BY: J. L. MYERS COMPANY DALLAS, TEXAS

DRILLERS: P. WESTBROOK, STEVE PRICE, K. WESTBROOK

COMPLETED: FEBRUARY 1978

DEPTH OF STRATA	EACH STRATUM	FORMATION	
0	23	3'	Surface Soil
23	48	25'	Sand and gravel
48	202	154'	Shale
202	444	242'	Chalk rock
444	855	411'	Shale
855	1183	328'	Shale with sand streaks
1183	1392	209'	Lime
1392	1920	528'	Lime and shale with sand streaks
1920	1960	40'	Lime
1960	2030	70'	Sand and shale
2030	2058	28'	Shale
2058	2100	42'	Sand
2100	2270	160'	Shale and lime with sand streaks
2270	2420	150'	Sand
2420	2461	41'	Shale with sand streaks

MATERIAL RECORD OF WATER WELL #3  
FOR CITY OF BELLMEAD, TEXAS

FEBRUARY, 1978

<u>FROM</u>	<u>TO</u>	<u>AMOUNT</u>	<u>DESCRIPTION</u>
0	57	57.0'	22" O.D., P.E., .375" wall, 86.6 lbs per foot, surface casing cemented in place.
+1.5	1410	1411.5'	16" O.D., P.E. & B, .375" wall, 62.58 lbs per foot, API 5L Grade B, Range 3, casing equipped with 16" X 10-3/4" P.E. & B swage nipple welded to 10-3/4" nipple.
1410	2270	860.0'	10-3/4" O.D., T&C, .350" wall, 40.5 lbs. per foot, AP1-J55, Range 3, casing equipped with casing shoe on bottom, #401 Larkin cement float collar near bottom, one Weatherford casing centralizer set at 2268' and one Weatherford casing centralizer set at 2228. Total casing cemented in place with 2035 cubic feet of cement slurry, cementing by Halliburton Company.
2212	2270	58.0'	7" O.D., T&C, .272" wall, 20 lbs. per foot, AP1-K55, Range 3, blank liner lapping inside 10-3/4" O.D. casing
2270	2422	152.0'	7" O.D., T&C, .272" wall, 20 lbs. per foot, AP1-K55, Range 3, mill slotted screen with .035", #110 staggered vertical slots on 6" centers, screen by Layne and Bowler Company of Houston, Texas
2422	2464	42.0'	7" O.D., T&C, .272" wall, 20 lbs. per foot, AP1-K55, Range 3 blank liner.

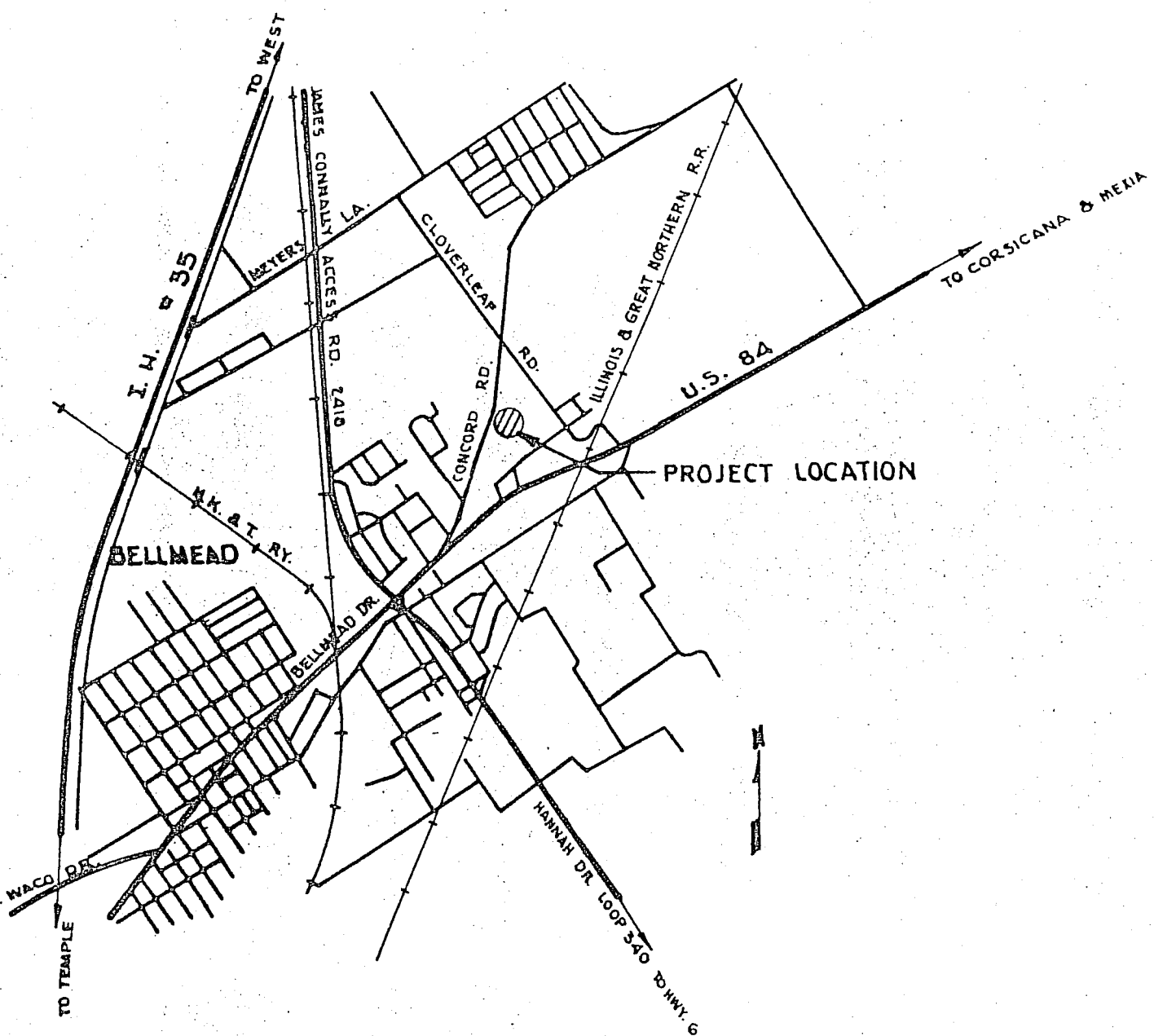

**PROJECT LOCATION MAP**



Record #3

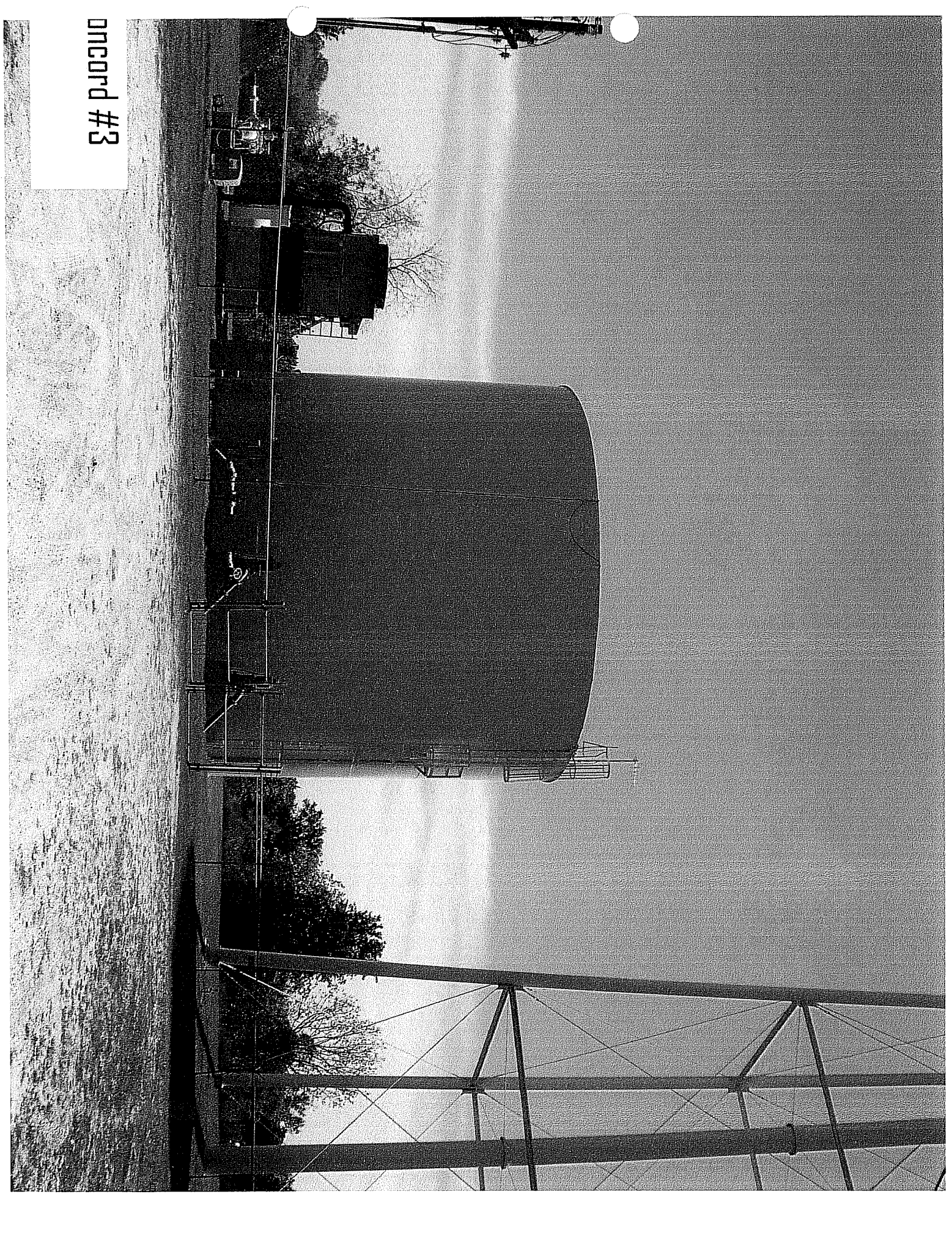



**SOUTHERN TRINITY GROUNDWATER CONSERVATION DISTRICT**

P. O. Box 2205  
 420 North 6th Street  
 Waco, Texas 76703

Phone: (254) 759-5610 [southerntrinitygcd@att.net](mailto:southerntrinitygcd@att.net)

**APPLICATION FOR HISTORIC USE PRODUCTION PERMIT**

**Part A – General Information**

**Instructions:** Please type or print legibly. Incomplete applications will not be accepted. Application Fee Required: A non-refundable application fee of \$1,000 must accompany this application. Only checks or money orders made payable to “Southern Trinity Groundwater Conservation District” will be accepted. **CASH IS NOT ACCEPTED.**

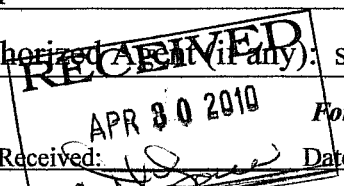
1. Applicant Information	<input type="checkbox"/> Individual	<input type="checkbox"/> Partnership	<input type="checkbox"/> Corporation
	<input checked="" type="checkbox"/> Government Entity	<input type="checkbox"/> Estate/Trust/Guardianship	
Permit Applicant's Name: City of Bellmead			
Physical Address: 3015 Bellmead Dr			
City: Bellmead	State: TX	Zip Code: 76705	
Mailing Address, (if different):			
City:	State:	Zip Code:	
Daytime Telephone Number: <del>Fax: 254-799-2436</del> fax:254-799-5969			
Email Address (if any): Scoleman@bellmead.com			
2. Name of Authorized Agent (if any): Scott Coleman			
Position: Public Works Director			
Physical Address: 3015 Bellmead Dr			
City: Bellmead	State: TX	Zip Code: 76705	
Mailing Address (if different):			
City:	State:	Zip Code:	
Daytime Telephone Numbers of Authorized Agent: 254-799-2436 Fax: 254-799-5969			
Email for Authorized Agent (if any): scoleman@bellmead.com			
<div style="text-align: center;">  </div>			
Date Application Received: <u>                    </u>		Date Admin. Fee Received: <u>                    </u> Amount of Fee: <u>                    </u>	

**Historic Groundwater Use and Production Information.**

3. Purpose of Historic Use: The purpose(s) for which the groundwater was used during the Historic Use Period.  Irrigation  Municipal  Industrial  
 Other (If Other, describe specifically):

4. Purpose of Future Use: Municipal

5. Is the place of use within the District boundaries:  Yes  No

6. If you answered No to Item 5, has a groundwater exportation permit been applied for or obtained from the District or is there a groundwater export agreement or contract in effect prior to January 7, 2010?  Yes  No *N/A*

7. If you answered Yes to Item 6, please describe the parties to the agreement, the location outside of the District that the water is used, the amount use, and pipeline route.  
*N/A*

8. Completely describe the place of use of groundwater withdrawn from the well:  
 City of Bellmead Public Water Supply

9. If groundwater was withdrawn from the well or placed to a beneficial use by a contract user or predecessor in interest, then provide the name, address, and telephone number of each contract user or predecessor in interest, and provide copies of the legal documents establishing the legal right of the contract user or predecessor in interest to withdraw and/or place groundwater from the well to beneficial use.

*N/A*

10. If applicable, provide a copy of the map identifying the boundaries of the applicant's Certificate of Convenience and Necessity (CCN).

11. If applicable, describe the number of connections to be serviced by the well: 3300

12. Maximum Historic Use. State the amount of water that you claim as your Maximum Historic Use during any one year of the Historic Use Period. Maximum Historic Use means the maximum amount of groundwater that an applicant for a Historic Use Production Permit proves was produced and beneficially used without waste from the applicant's non-exempt well during any one calendar year of the Historic Use Period.

Amount: 125,446,000                      Units: Million Gal                      Year: 2007

13. Provide your use amounts for each year groundwater was withdrawn during the Historical Use Period. If no groundwater was withdrawn for a period listed below, place a zero (0) in the appropriate space (typical units are in gallons, 100 gallons, 1000 gallons, or acre-feet).

2009	Amount: 93,652,000	Units: Million Gal
2008	Amount: 97,909,000	Units: Million Gal
2007	Amount: 125,446,000	Units: Million Gal
2006	Amount: 83,717,000	Units: Million Gal
2005	Amount: 93,955,000	Units: Million Gal
2004	Amount: 64,871,000	Units: Million Gal
2003	Amount:	Units: Million Gal
2002	Amount:	Units: Million Gal
2001	Amount:	Units: Million Gal
2000	Amount: 121,444,000	Units: Million Gal

14. Attach documents to substantiate your claim of Maximum Historic Use. Documentation may include, but is not limited to: production logs showing amount of water pumped, copies of reports to the Texas Commission on Environmental Quality, the Texas Water Development Board, or the Texas Department of Health; reports filed with or created by the Natural Resource Conservation Service or Farm Services Agency or aerial photographs; reports filed with or created by soil and water conservation districts; fuel and electricity use records; and calculations used to estimate well discharge rates if the well discharge is not metered. The purpose of supporting documentation is to substantiate your declaration. The information you provide should be labeled, indexed and in a form that can be easily reviewed by the District.

15. Will the proposed use of water unreasonably affect existing groundwater and surface water resources or existing permit holders?  Yes  No

16. Is the proposed use of water dedicated to a beneficial use?  Yes  No

17. Is the proposed use of water consistent with the District's management plan?  Yes  No

**STATEMENT OF COMPLIANCE WITH DISTRICT GROUNDWATER MANAGEMENT PLAN, DISTRICT RULES, AND COMMITMENT TO WATER CONSERVATION AND WATER QUALITY PROTECTION**

Please check all that apply:

- Applicant will comply with the District's Groundwater Management Plan.
- Applicant is in compliance with all applicable District rules in effect since December 7, 2007 and will comply with the District's rules.
- Applicant agrees to avoid waste and achieve water conservation.
- Applicant agrees to use reasonable diligence to protect groundwater quality and will follow the District's well plugging guidelines at the time of well closure.
- Applicant affirms that activities constituting the purpose of use for which the groundwater will be beneficially used will be managed to preserve, protect, prevent the pollution, degradation, or harmful alteration of, control and prevent the waste of, prevent the escape of groundwater from, and achieve the conservation of groundwater in and produced from, the aquifer.

**CERTIFICATION†**

I, the undersigned applicant, subscribe and affirm that the information provided herein is true and correct. I also understand that it shall be considered to be a fraud upon the District for any applicant to knowingly give erroneous information in this application.

Signed:   
Printed Name: Scott Coleman

Date: 4-15-10  
Title: Public Works Director

† If the applicant is an individual, the application shall be signed by the applicant or a duly appointed agent. An agent shall provide written evidence of his or her authority to represent the applicant. If the applicant is an individual doing business under an assumed name, the applicant shall attach to the application an assumed name certificate filed with the county clerk of the county in which the principal place of business is located or with the Texas Secretary of State.

A joint application shall be signed by each applicant or each applicant's duly authorized agent with written evidence of such agency submitted with the application. If a well or proposed well is owned by both husband and wife, each person shall sign the application. Joint applicants shall select one among them to act for and represent the others in pursuing the application with the District with written evidence of such representation to be submitted with the application.

If the application is by a partnership, the application shall be signed by one of the general partners. If the applicant is a partnership doing business under an assumed name, the applicant shall attach to the application an assumed name certificate filed with the county clerk of the county in which the principal place of business is located or with the Texas Secretary of State. The name of the partnership must be followed by the words "a partnership." If the applicant is an estate or guardianship, the application shall be signed by the duly appointed guardian or representative of the estate and a current copy of the letters testamentary issued by the court shall be attached to the application.

If the applicant is a corporation, public district, county, municipality or other corporate entity, the application shall be signed by a duly authorized official. Written evidence in the form of bylaws, charters, or resolutions specifying the authority of the official to take such action shall be submitted along with the application. A corporation may file a corporate affidavit as evidence of a corporate official's authority to sign.

If the applicant is acting as trustee for another, the applicant shall sign as trustee and in the application shall disclose the nature of the trust agreement and give the name and current address of each trust beneficiary. The application must designate the trustee's name followed by the word "trustee," and the name of the trust for which the trustee is acting.

STATE OF TEXAS §

§

COUNTY OF §

BEFORE ME, a notary public, on this day personally appeared: Scott Coleman  
\_\_\_\_\_ who stated that: (1) he/she has read the  
foregoing application and any supporting attachments and that the statements contained  
therein are true and accurate; and (2) that he/she is duly authorized to sign this  
application on behalf of the permit applicant.

Subscribed and sworn to before me on this 29<sup>th</sup> day of April, 2010.

Cynthia R. Ward

Notary Signature

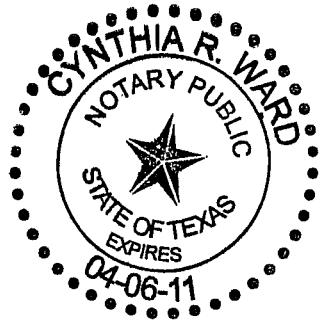

**STGWCD- HUPP Application - Part B – Well Information (one form per well)**

1. Applicant Name: City of Bellmead			
2. Well Identifier or Well Name: Myers #4			
3. System Name: City of Bellmead			
4. TCEQ System ID Number: 1550001			
5. If applicable, please attach a copy of the applicant's most recent water conservation plan and drought contingency plan prepared for TCEQ.			
6. TWDB ID Number: 4032107			
7. Aquifer(s) or formations in which the well is screened: Trinity			
8. Address of the property upon which the well is located: 4410 Myers Ln			
9. Well Location:	Latitude:	31 D	37 M 8.46 S
	Longitude:	-97 D	5 M 32.348 S
10. Identify any surface water, including lakes or rivers within 1,000 feet of the well: N/A			
11. Well or Driller's Log. Please attach a copy of the State Well Report and, if available, any geophysical logs for the well.			
12. Please attach a photograph of the well taken approximately 100 feet from the well.			
13. Please attach a copy of a recorded deed or other legal document verifying the applicant's ownership of the well. Disregard this requirement if the deed was sent with your Application for Interim Production Status and there has been no change.			
14. Year well drilled: 1987 Year well completed and operational: 1987			
15. Pump Information: Pump Make and Model: Byron Jackson 11mqc 17 stage			
Pump power source: <input checked="" type="checkbox"/> Electric <input type="checkbox"/> Diesel <input type="checkbox"/> Natural Gas <input type="checkbox"/> Other			
Casing Material <input checked="" type="checkbox"/> Steel <input type="checkbox"/> PVC			
Size of well casing: 16, 10-3/4 inches Inside diameter of column pipe: 8 inches			
16. The maximum rate at which water can be withdrawn from the well: 700 gpm			
17. Flow Meter Make and Model: Sensus Propeller-300			
Serial Number: 51518		Meter Units: Gal 1000	
Meter reading end of 2008: Amount: 374817		Units: Gal 1000	Date: 12-31-08
Meter reading end of 2009: Amount: 468469		Units: Gal 1000	Date: 12-31-09

RECORD OF TRINITY SANDS WATER WELL  
FOR

CITY OF BELLMEAD  
WELL NO. 5

*Myers Co.*

DRILLED BY: J. L. MYERS COMPANY  
8325 FORNEY ROAD  
DALLAS, TEXAS 75227  
(214) 388-7407

ENGINEERS : TABOR & ASSOCIATES, INC.  
1905 WASHINGTON AVENUE  
WACO, TEXAS 76703  
(817) 756-2118

DRILLER'S LOG

OWNER : CITY OF BELLMEAD, WELL NO. 5

LOCATION: ON MYERS LANE, BELLMEAD, MCLENNAN COUNTY, TEXAS

DATE : FEBRUARY, 1987

DRILLERS: L. BERNARD, B. WESTBROOK

DEPTH OF STRATA		EACH STRATUM	DESCRIPTION
From	To	Feet	
0	2	2	Top soil
2	15	13	Clay
15	21	6	Sandy clay
21	28	7	Fine gravel
28	33	5	Yellow clay
33	47	14	Gummy shale
47	134	87	Shale
134	151	17	Sand
151	166	15	Shale
166	381	215	Chalk
381	549	168	Shale
549	561	12	Gumbo shale
561	685	124	Shale
685	711	26	Gumbo shale
711	744	33	Mixed shale, hard sandy lime
744	747	3	Sandy lime
747	784	37	Gumbo shale
784	803	19	Shale, silty gray shale
803	1052	249	Lime
1052	1065	13	Shale and lime
1065	1070	5	Shale
1070	1105	35	Shale and lime
1105	1117	12	Shale
1117	1266	149	Lime and shale
1266	1307	41	Lime streaks, shale mostly
1307	1320	13	Shale and lime
1320	1387	67	Sandy lime, shale
1387	1430	43	Lime, shale
1430	1445	15	Mostly shale
1445	1475	30	Shale, lime
1475	1490	15	Lime, shale



CITY OF BELLMEAD, WELL NO. 5  
 DRILLER'S LOG CONTINUED

DEPTH OF STRATA		EACH STRATUM	DESCRIPTION
From	To	Feet	
1490	1581	91	Hard lime
1581	1595	14	Sandy lime
1595	1658	63	Hard lime
1658	1673	15	Hard limestone
1673	1695	22	Lime
1695	1723	28	Blue shale
1723	1762	39	Mostly shale
1762	1974	212	Lime
1974	2007	33	Lime, red lignite
2007	2030	23	Lime
2030	2065	35	Sandy, hard tight sand
2065	2121	56	Sand and shale, lime
2121	2180	59	Sand, shale
2180	2213	33	Sand, trace red bed
2213	2319	106	Water sand with shale, lime
2319	2326	7	Sand
2326	2360	34	Sand, shale, lime mixed with red bed
2360	2390	30	Water sand
2390	2410	20	Red bed

J. L. MYERS COMPANY  
 8325 FORNEY ROAD  
 DALLAS, TEXAS 75227

MATERIAL SETTING

OWNER : CITY OF BELLMEAD, WELL NO. 5

LOCATION: ON MYERS LANE, BELLMEAD, MCLENNAN COUNTY, TEXAS

DATE : FEBRUARY 1987

FROM	TO	AMOUNT	DESCRIPTION
0	2150	2150	16" OD casing set and cemented by Halli- burton using 1400 sacks of premium cement with 8% gel added
2114	2154	40	10-3/4" blank liner
2154	2178	24	10-3/4" mill slotted screen
2178	2182	4	10-3/4" blank liner
2182	2220	38	10-3/4" screen
2220	2224	4	10-3/4" blank liner
2224	2368	144	10-3/4" screen
2368	2372	4	10-3/4" blank liner
2372	2388	16	10-3/4" screen
2388	2410	22	10-3/4" blank liner

J. L. MYERS COMPANY  
8325 FORNEY ROAD  
DALLAS, TEXAS 75227



Meyers Well

**TWDB GROUNDWATER DATA (Explanation)**

Rec	OBJECT	State Well Number	Owner	Water Use	Elevation	Well Depth	Water Level	Water Quality	Aquifer Code	Latitude	Longitude	COUNTY_CODE	WELL_TYP
1	48595428	4032107	City of Bellmead	P	481	2410	P	Y	217HSTN	313710	970530	309	W

Ayers # 4

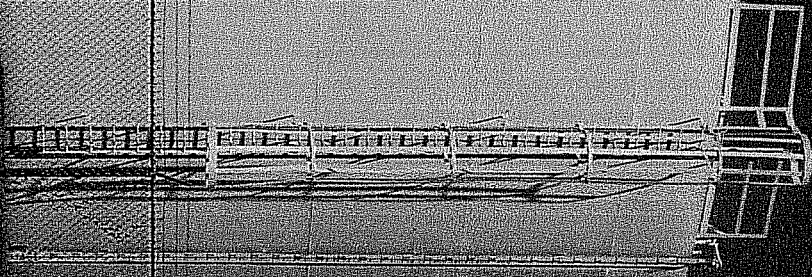

**SOUTHERN TRINITY GROUNDWATER CONSERVATION DISTRICT**

P. O. Box 2205  
 420 North 6th Street  
 Waco, Texas 76703

Phone: (254) 759-5610 [southerntrinitygcd@att.net](mailto:southerntrinitygcd@att.net)

**APPLICATION FOR HISTORIC USE PRODUCTION PERMIT**

**Part A – General Information**

**Instructions:** Please type or print legibly. Incomplete applications will not be accepted. Application Fee Required: A non-refundable application fee of \$1,000 must accompany this application. Only checks or money orders made payable to “Southern Trinity Groundwater Conservation District” will be accepted. **CASH IS NOT ACCEPTED.**

1. Applicant Information		
<input type="checkbox"/> Individual	<input type="checkbox"/> Partnership	<input type="checkbox"/> Corporation
<input checked="" type="checkbox"/> Government Entity	<input type="checkbox"/> Estate/Trust/Guardianship	
Permit Applicant's Name: City of Bellmead		
Physical Address: 3015 Bellmead Dr		
City: Bellmead	State: Tx	Zip Code: 76705
Mailing Address, (if different):		
City:	State:	Zip Code:
Daytime Telephone Number: <del>Fax:</del> 799-2436, Fax: 799-5969		
Email Address (if any):		
2. Name of Authorized Agent (if any): Scott Coleman		
Position: Public Works Director		
Physical Address: 3015 Bellmead Dr		
City: Bellmead	State: Tx	Zip Code: 76705
Mailing Address (if different):		
City:	State:	Zip Code:
Daytime Telephone Numbers of Authorized Agent: 254-799-2436 Fax: 254-799-5969		
Email for Authorized Agent (if any): Scoleman@bellmead.com		
<div style="border: 1px solid black; padding: 5px; display: inline-block;"> <p style="margin: 0;"><b>RECEIVED</b></p> <p style="margin: 0;">APR 30 2010</p> <p style="margin: 0; font-size: small;">For District Use Only</p> </div>		
Date Application Received:	Date Admin. Fee Received:	Amount of Fee:
<div style="border: 1px solid black; padding: 2px; display: inline-block;"> <p style="margin: 0;">BY: <u>[Signature]</u></p> </div>		



**Historic Groundwater Use and Production Information.**

3. Purpose of Historic Use: The purpose(s) for which the groundwater was used during the Historic Use Period.  Irrigation  Municipal  Industrial  
 Other (If Other, describe specifically):

4. Purpose of Future Use: Municipal

5. Is the place of use within the District boundaries:  Yes  No

6. If you answered No to Item 5, has a groundwater exportation permit been applied for or obtained from the District or is there a groundwater export agreement or contract in effect prior to January 7, 2010?  Yes  No *N/A*

7. If you answered Yes to Item 6, please describe the parties to the agreement, the location outside of the District that the water is used, the amount use, and pipeline route.  
*N/A*

8. Completely describe the place of use of groundwater withdrawn from the well:  
 City of Bellmead Public Water Supply

9. If groundwater was withdrawn from the well or placed to a beneficial use by a contract user or predecessor in interest, then provide the name, address, and telephone number of each contract user or predecessor in interest, and provide copies of the legal documents establishing the legal right of the contract user or predecessor in interest to withdraw and/or place groundwater from the well to beneficial use.

N/A

10. If applicable, provide a copy of the map identifying the boundaries of the applicant's Certificate of Convenience and Necessity (CCN).

11. If applicable, describe the number of connections to be serviced by the well: 3300

12. Maximum Historic Use. State the amount of water that you claim as your Maximum Historic Use during any one year of the Historic Use Period. Maximum Historic Use means the maximum amount of groundwater that an applicant for a Historic Use Production Permit proves was produced and beneficially used without waste from the applicant's non-exempt well during any one calendar year of the Historic Use Period.

Amount: 154.910,000

Units: Million Gal

Year:2007

13. Provide your use amounts for each year groundwater was withdrawn during the Historical Use Period. If no groundwater was withdrawn for a period listed below, place a zero (0) in the appropriate space (typical units are in gallons, 100 gallons, 1000 gallons, or acre-feet).

2009	Amount: 151,603,000	Units: Million Gal
2008	Amount: 129,964,000	Units: Million Gal
2007	Amount: 154,910,000	Units: Million Gal
2006	Amount: 145,488,000	Units: Million Gal
2005	Amount: 116,684,000	Units: Million Gal
2004	Amount: 101,219,000	Units: Million Gal
2003	Amount: Missing Records	Units: Million Gal
2002	Amount: Missing Records	Units: Million Gal
2001	Amount: Missing Records	Units: Million Gal
2000	Amount: 147,184,000	Units: Million Gal

14. Attach documents to substantiate your claim of Maximum Historic Use. Documentation may include, but is not limited to: production logs showing amount of water pumped, copies of reports to the Texas Commission on Environmental Quality, the Texas Water Development Board, or the Texas Department of Health; reports filed with or created by the Natural Resource Conservation Service or Farm Services Agency or aerial photographs; reports filed with or created by soil and water conservation districts; fuel and electricity use records; and calculations used to estimate well discharge rates if the well discharge is not metered. The purpose of supporting documentation is to substantiate your declaration. The information you provide should be labeled, indexed and in a form that can be easily reviewed by the District.

15. Will the proposed use of water unreasonably affect existing groundwater and surface water resources or existing permit holders?  Yes  No

16. Is the proposed use of water dedicated to a beneficial use?  Yes  No

17. Is the proposed use of water consistent with the District's management plan?  Yes  No



STATE OF TEXAS §

§

COUNTY OF §

BEFORE ME, a notary public, on this day personally appeared: Scott Coleman  
\_\_\_\_\_ who stated that: (1) he/she has read the  
foregoing application and any supporting attachments and that the statements contained  
therein are true and accurate; and (2) that he/she is duly authorized to sign this  
application on behalf of the permit applicant.

Subscribed and sworn to before me on this 29<sup>th</sup> day of April, 2010.

Cynthia R. Ward

Notary Signature

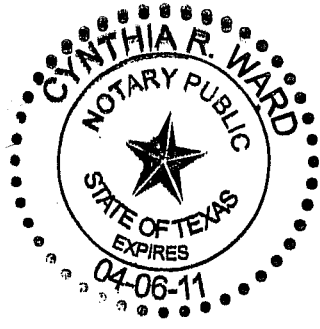

**STATEMENT OF COMPLIANCE WITH DISTRICT GROUNDWATER MANAGEMENT PLAN, DISTRICT RULES, AND COMMITMENT TO WATER CONSERVATION AND WATER QUALITY PROTECTION**

Please check all that apply:

- Applicant will comply with the District’s Groundwater Management Plan.
- Applicant is in compliance with all applicable District rules in effect since December 7, 2007 and will comply with the District’s rules.
- Applicant agrees to avoid waste and achieve water conservation.
- Applicant agrees to use reasonable diligence to protect groundwater quality and will follow the District’s well plugging guidelines at the time of well closure.
- Applicant affirms that activities constituting the purpose of use for which the groundwater will be beneficially used will be managed to preserve, protect, prevent the pollution, degradation, or harmful alteration of, control and prevent the waste of, prevent the escape of groundwater from, and achieve the conservation of groundwater in and produced from, the aquifer.

**CERTIFICATION†**

I, the undersigned applicant, subscribe and affirm that the information provided herein is true and correct. I also understand that it shall be considered to be a fraud upon the District for any applicant to knowingly give erroneous information in this application.

Signed:                     *Scott Coleman*                      
Printed Name:                     Scott Coleman                    

Date:                     4-15-10                      
Title:                     Public Works Director                    

† If the applicant is an individual, the application shall be signed by the applicant or a duly appointed agent. An agent shall provide written evidence of his or her authority to represent the applicant. If the applicant is an individual doing business under an assumed name, the applicant shall attach to the application an assumed name certificate filed with the county clerk of the county in which the principal place of business is located or with the Texas Secretary of State.

A joint application shall be signed by each applicant or each applicant’s duly authorized agent with written evidence of such agency submitted with the application. If a well or proposed well is owned by both husband and wife, each person shall sign the application. Joint applicants shall select one among them to act for and represent the others in pursuing the application with the District with written evidence of such representation to be submitted with the application.

If the application is by a partnership, the application shall be signed by one of the general partners. If the applicant is a partnership doing business under an assumed name, the applicant shall attach to the application an assumed name certificate filed with the county clerk of the county in which the principal place of business is located or with the Texas Secretary of State. The name of the partnership must be followed by the words “a partnership.” If the applicant is an estate or guardianship, the application shall be signed by the duly appointed guardian or representative of the estate and a current copy of the letters testamentary issued by the court shall be attached to the application.

If the applicant is a corporation, public district, county, municipality or other corporate entity, the application shall be signed by a duly authorized official. Written evidence in the form of bylaws, charters, or resolutions specifying the authority of the official to take such action shall be submitted along with the application. A corporation may file a corporate affidavit as evidence of a corporate official’s authority to sign.

If the applicant is acting as trustee for another, the applicant shall sign as trustee and in the application shall disclose the nature of the trust agreement and give the name and current address of each trust beneficiary. The application must designate the trustee’s name followed by the word “trustee,” and the name of the trust for which the trustee is acting.

**STGWCD- HUPP Application - Part B – Well Information (one form per well)**

1. Applicant Name: City of Bellmead			
2. Well Identifier or Well Name: Parrish #1			
3. System Name: City of Bellmead			
4. TCEQ System ID Number: 1550001			
5. If applicable, please attach a copy of the applicant's most recent water conservation plan and drought contingency plan prepared for TCEQ.			
6. TWDB ID Number: 4032102			
7. Aquifer(s) or formations in which the well is screened: Trinity			
8. Address of the property upon which the well is located: 2801 Parrish Dr.			
9. Well Location:	Latitude:	31 D	35 M 35.022 S
	Longitude:	-97 D	6 M 25.869 S
10. Identify any surface water, including lakes or rivers within 1,000 feet of the well: n/a			
11. Well or Driller's Log. Please attach a copy of the State Well Report and, if available, any geophysical logs for the well.			
12. Please attach a photograph of the well taken approximately 100 feet from the well.			
13. Please attach a copy of a recorded deed or other legal document verifying the applicant's ownership of the well. Disregard this requirement if the deed was sent with your Application for Interim Production Status and there has been no change.			
14. Year well drilled: 1948 Year well completed and operational: 1948			
15. Pump Information: Pump Make and Model: Centrilift hphvl675hc20000			
Pump power source: <input checked="" type="checkbox"/> Electric <input type="checkbox"/> Diesel <input type="checkbox"/> Natural Gas <input type="checkbox"/> Other			
Casing Material <input checked="" type="checkbox"/> Steel <input type="checkbox"/> PVC			
Size of well casing: 13,8,6 inches Inside diameter of column pipe: 6,4 inches			
16. The maximum rate at which water can be withdrawn from the well: 600 gpm			
17. Flow Meter Make and Model: Sensus Propeller 300			
Serial Number: 51494		Meter Units: Gal 1000	
Meter reading end of 2008: Amount: 549590		Units: Gal Thous	Date: 12-31-08
Meter reading end of 2009: Amount: 701163		Units: Gal Thous	Date: 12-31-09

Table 3.—Drillers' Logs of Selected Wells in McLennan County—Continued

	THICKNESS (FEET)	DEPTH (FEET)		THICKNESS (FEET)	DEPTH (FEET)
<b>Well ST-40-31-802—Continued</b>			<b>Well ST-40-31-804—Continued</b>		
Sand and lime	25	1,694	Broken shale	47	1,711
Sand and lime	6	1,700	Broken lime	55	1,766
Shale	14	1,714	Broken sand	98	1,864
Shale and layers of sandy shale	20	1,734	Shale	6	1,870
Shale	30	1,764	<b>Well ST-40-31-902</b>		
Shale and sand	6	1,770	Owner: City of Waco Driller: Fowler Construction		
Shale and red bed	17	1,787	No record	1,808	1,808
Sand	18	1,805	Sandstone	54	1,862
Sand, lime and shale	4	1,809	Shale	4	1,866
Sand, shale and red bed	16	1,825	Sandstone	28	1,894
Shale	22	1,847	Limestone	12	1,906
Sandy shale	3	1,850	Gravel	3	1,909
Shale	6	1,856	Sandstone	171	2,080
Sand	16	1,872	Black sand	131	2,211
Sand and shale	34	1,906	Rock	59	2,270
Sand	12	1,918	Red shale	82	2,352
Shale	5	1,923	Shale	8	2,360
Sand	37	1,960	Rock	50	2,410
Shale	4	1,964	<div style="border: 1px solid black; border-radius: 50%; padding: 5px; display: inline-block;">Well ST-40-32-102</div> Owner: City of Bellmead Driller: Layne Texas Co.		
Sand and shale breaks	7	1,971			
Shale (hard)	8	1,979	Soil and clay	15	15
Shale (sandy)	29	2,008	Gravel	5	20
Shale	12	2,020	Shale	10	30
Sandy shale	9	2,029	Blue shale	54	84
Shale (hard)	11	2,040	Shale and lime	220	304
<b>Well ST-40-31-804</b>			Shale	264	568
Owner: Midway Water Co. Driller: J. L. Myers Sons			Shale and lime streaks	123	691
Surface soil	9	9	Lime	25	716
Chalk rock	159	168	Lime and shale	48	764
Shale	292	460	Lime and hard shale	37	801
Broken lime	114	574	Lime and shale	429	1,230
Lime	66	640	Soft lime and shale	198	1,428
Broken lime	35	675	Shale and lime	432	1,860
Lime	142	817	Shale and sandy shale	25	1,885
Broken lime	798	1,615	Sand and sandy shale breaks	40	1,925
Broken sand	49	1,664			

*- Parrish*

MC LEWIS COUNTY

Table 1. -- Records of Selected Water Wells -- Continued

WELL	OWNER	DRILLER	DATE COMPLETED	DEPTH OF WELL (ft.)	CASTING			WATER BEARING UNIT	ALTITUDE ABOVE SURFACE (ft.)	HEIGHT ABOVE (+) OR BELOW (-) SURFACE DATUM (ft.)	DATE OF MEASUREMENT	METHOD OF LIFT	USE OF WATER	REMARKS
					DIAMETER (in.)	DEPTH (ft.)	WATER LEVEL							
* ST-40-31-901	City of Waco	Swart Rout Bros.	1948	1,560	--	--	Khe	495	--	--	T, E 20	P	Abandoned. <u>Y</u>	
902	do.	Fowler Construction	--	2,410	--	--	Ktp	500	+138	1913	N	N	Perforated from 2,200 to 2,400 ft. Pump set at 413 ft. Reported yield 165 gpm. Temp. 87°F. <u>Y</u>	
* 32-101	City of Bellmead	J. L. Myers Sons	1949	2,400	10	29	Kho	445	--	--	T, E	P	Slotted from 2,115 to 2,287 ft. Pumping level 222 ft. at 400 gpm on June 27, 1948. Pump set at 600 ft. Reported yield 500 gpm. Cemented from 2,115 ft. to surface. Temp. 116°F. <u>Y</u>	
* 102	STAD do. 32-102	Layne Texas Co.	1948	2,303	5	2,400	do.	435	+180	June 15, 1948 June 9, 1949 June 9, 1962	T, E 75	P	Slotted from 2,198 to 2,392 ft. Pumping level 381 ft. at 615 gpm on May 22, 1957. Pump set at 520 ft. Cemented from 2,198 ft. to surface. Temp. 115°F. <u>Y</u>	
* 103	STAD do. 32-103	J. L. Myers Sons	1957	2,396	20	53	do.	440	160	May 21, 1957 Dec. 1960	T, E 175	P	Slotted from 2,153 to 2,220 ft. Pumping level 454 ft. at 300 gpm on Dec. 13, 1960. Pump set at 650 ft. Cemented from 2,153 ft. to surface. <u>Y</u>	
* 104	City of Lacy - Lakeview	J. L. Myers Sons	1960	2,329	13	905	Kho	478	250	Dec. 13, 1960 Mar. 1964	Sub, E 100	P	Perforated. <u>Y</u>	
* 106	Plantation Foods, Inc.	Smith and Bra shaw Pump Co.	1965	2,255	--	--	Ktp	440	--	--	--	Ind	Perforated. <u>Y</u>	
201	Frank B. Tixey	J. L. Myers Sons	1951	2,511	6	617	do.	440	--	--	--	D, S	Perforated. <u>Y</u>	
* 403	General Tire and Rubber Co.	Layne Texas Co.	1944	2,312	16	697	Kho	407	+30	July 18, 1944 1960 June 22, 1964	Sub, E 100	Ind	Slotted from 2,110 to 2,311 ft. Pumping level 257 ft. at 726 gpm on July 22, 1944. Pump set at 400 ft. Reported yield 750 gpm. Cemented from 697 ft. to surface. Temp. 115°F. <u>Y</u>	
404	do.	do.	1945	2,376	16	725	do.	405	+30	1949 1964 Oct. 1961	T, E 125	Ind	Slotted from 2,133 to 2,312 and 2,352 to 2,374 ft. Pump set at 450 ft. Cemented from 726 ft. to surface. Temp. 115°F. <u>Y</u>	
* 405	Texas Power and Light Co.	HILL, Green, Dearing and Sen	1914	2,147	8	749	Ktp	387	89	1914 1949	T, E 30	Ind	Reported Flowed 550 gpm in 9 Temp. 115°F. <u>Y</u>	
* 501	City of Waco	J. L. Myers Sons	1958	2,493	16	53	Kho	445	193	July 17, 1958 Apr. 5, 1969	Sub, E 40	P	Slotted from 2,331 to 2,464 ft. Pumping level 344 ft. at 300 gpm on July 7, 1958. Pump set at 360 ft. Cemented from 2,331 ft. to surface. Temp. 114°F. Texas Water Development Board observation well. <u>Y</u>	
502	do.	do.	1949	2,500	10	40	do.	460	--	--	N	N	Slotted from 2,337 to 2,500 ft. Well plugged. <u>Y</u>	
* 37-501	City of McGregor	Harvey Meadows and Son Well Driller	1965	1,340	10	970	Khe	729	400	Apr. 29, 1965 Mar. 7, 1969	Sub, E 75	P	Completed from 980 to 1,050 ft. Pumping level 597 ft. at 153 gpm on Mar. 11, 1965. Pump set at 970 ft. Reported yield 220 gpm. Cemented from observation well. Texas Water Development Board observation well. <u>Y</u>	
* 601	do.	-- Darley	1908	1,028	12	--	do.	690	150	1943 1962	T, E 50	P	Pump set at 500 ft. Reported yield 250 gpm. Temp. 85°F.	
* 602	do.	Layne Texas Co.	1942	1,250	8	977	Khe, Kpe	690	175	Aug. 31, 1942	N	N	Completed from 975 to 1,045, 1,045 to 1,056 to 1,066 and 1,136 to 1,180 ft. Pumping level 565 ft. at 275 gpm in May 1959. Reported yield 50 gpm. Well plugged and abandoned. <u>Y</u>	

Parrish  
Barlow

See footnotes at end of table.

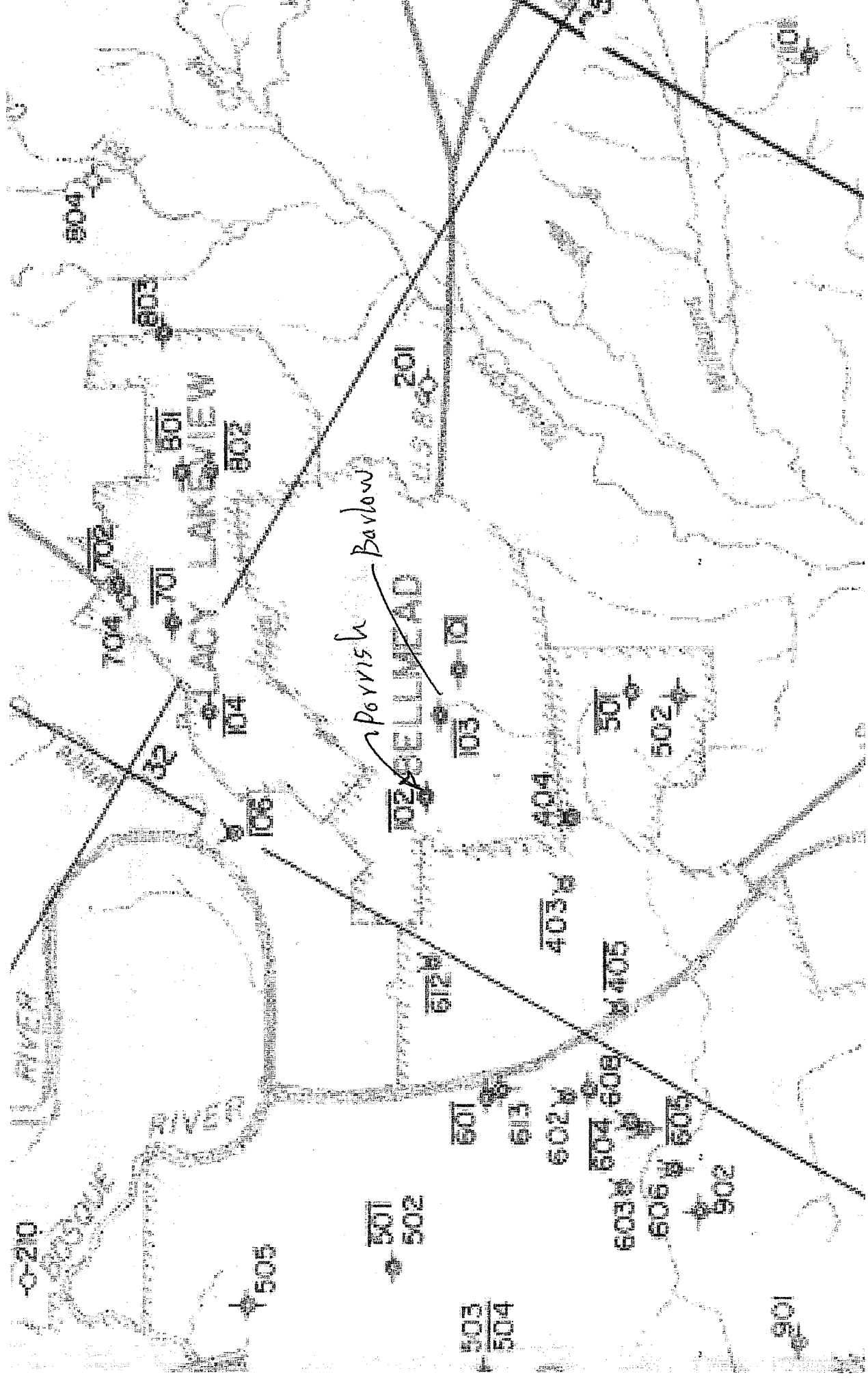

Parrish Barlow

BELLHEAD

C-210

LAKESIDE

504

803

801

802

704

701

104

105

201

102

101

103

404

403

501

502

705

612

601

613

602

604

605

603

606

902

505

501

502

503

504

901

*Parrish Well*

**TWDB GROUNDWATER DATA (Explanation)**

Rec	OBJECT	State Well Number	Owner	Water Use	Elevation	Well Depth	Water Level	Water Quality	Aquifer Code	Latitude	Longitude	COUNTY_CODE	WELL_TYP
1	48595423	4032102	City of Bellmead	P	435	2303	P	Y	217HSTN	313535	970623	309	W



arrish #1

